



MORGAN COUNTY

February 20, 2025
Re: RFP 2025-0320-001

Morgan County is inviting you to a scheduled Zoom meeting for RFP 2025-0320-001 Bid Opening.

Topic: RFP 2025-0320-001 Asphalt Paving Projects
Time: Mar 20, 2025 09:00 AM Mountain Time (US and Canada)
Join Zoom Meeting
<https://us02web.zoom.us/j/85986290925?pwd=7PHQd1d8LapfMsaqxbN5xvRv4YKooT.1>

Meeting ID: 859 8629 0925
Passcode: 905712

One tap mobile
+17193594580,,85986290925#,,,,*905712# US
+12532050468,,85986290925#,,,,*905712# US

Dial by your location

- +1 719 359 4580 US
- +1 253 205 0468 US
- +1 253 215 8782 US (Tacoma)
- +1 346 248 7799 US (Houston)
- +1 669 444 9171 US
- +1 669 900 9128 US (San Jose)
- +1 360 209 5623 US
- +1 386 347 5053 US
- +1 507 473 4847 US
- +1 564 217 2000 US
- +1 646 558 8656 US (New York)
- +1 646 931 3860 US
- +1 689 278 1000 US
- +1 301 715 8592 US (Washington DC)
- +1 305 224 1968 US
- +1 309 205 3325 US
- +1 312 626 6799 US (Chicago)

Meeting ID: 859 8629 0925
Passcode: 905712

Find your local number: <https://us02web.zoom.us/j/85986290925?pwd=7PHQd1d8LapfMsaqxbN5xvRv4YKooT.1>

Mindi Cloyd
Administrative Services Manager
Morgan County, Colorado



REQUESTS FOR PROPOSALS
RFP 2025-0320-001 Asphalt Paving Projects

The Board of County Commissioners will receive sealed proposals for the 2025 Asphalt Paving Projects, until 4:00 p.m. MST, Wednesday, March 19, 2025 at the office of the County Commissioners, 218 West Kiowa Ave, Fort Morgan, Colorado. All responses will be publicly opened and read aloud 9:00 a.m. MST, Thursday, March 20, 2025. Location of proposal openings will be at 231 Ensign, Fort Morgan, Colorado, Assembly Room, basement of the Administration Building. Vendors and/or the public will be able to view RFP opening via a Zoom meeting. Details will be posted on the county website at: <https://morgancounty.colorado.gov/bids-and-proposals>.

The RFP is on file in the office of Administrative Services Department at 218 West Kiowa Avenue, Fort Morgan, CO and also on the Morgan County Website at www.co.morgan.co.us.

All Proposals can be submitted as follows:

- **Email** – Proposals may be emailed to: bccadmin@co.morgan.co.us. Emailed proposals must include the following statement on the email: **“I hereby waive my right to a sealed proposal”**. An email confirmation will be sent when the County receives the proposal within 24 hours of normal business hours.
- **Hand delivery** - Two (2) copies of the proposal may be hand delivered to the Office of the Board of County Commissioners, 218 W. Kiowa Ave. Fort Morgan, CO 80701.
- **Mail** - All proposals must be clearly marked on the envelope **RFP 2025-0320-001**.

Please address as follows:

Morgan County
Attn: Mindi Cloyd, Administrative Services Manager
218 W Kiowa Ave
Fort Morgan, CO 80701

[Mindi Cloyd](#)
Mindi Cloyd
Administrative Services Manager
Morgan County, Colorado

TABLE OF CONTENTS

PROPOSAL INFORMATION DOCUMENTS

Requests for Proposal	Page 1
Table of Contents	Page 2
General Instructions to Responders	Page 3

WORK DOCUMENTS

Specific Project Requirements	Page 6
Reply Form	Page 7
Project Schedule 1	Page 8
Project Schedule 2	Page 11
Project Schedule 3	Page 13
Project Schedule 4	Page 15
Project Schedule 5	Page 17
Project Schedule 6	Page 19
Project Schedule 7	Page 21
Responder References Form	Page 23
Attachment A Work Site GPS Coordinates	Page 25
Attachment B County Map Work Sites	Page 26

*Complete packet contains 26 pages of documents

GENERAL INSTRUCTIONS AND PROPOSAL REQUIREMENTS

1. A proposal is a responsive, conforming, unconditional, complete, legible, and properly executed offer by a responder to provide the product/service specified in the Request for Proposal (RFP) for the compensation specified.
2. Responses shall be clearly marked with the **RFP 2025-0320-001**, Company Name, contact person, mailing address, telephone number of the responder, and contact email address.
3. **All proposals submitted must include two (2) copies of the following documents: Completed Proposal Reply Form, Completed Project Schedule documents (if applicable), References Form, and be accompanied by a bid bond, described below. Failure to submit all required documents may result in rejection of the proposal.**
4. All proposals must be accompanied by a bid bond made payable to the County in an amount of five percent (5%) of the responders total proposed price, and in the form of a certified check, bank check, or a bid bond issued by a surety contingent upon award. Upon award, such bid bonds shall be returned to the unsuccessful responder(s). For the successful responder, the bid bond will be returned upon receipt of the required payment and performance bond, in the full amount of the contract price within the period of the notice of award. Failure to return executed contracts and required payment and performance bond within the deadline stated in the notice of award will result in forfeiture of the bid bond.
5. It shall be the responsibility of the responder to ensure that the proposal is in proper form and in the County's possession on or before the time and date designated in the RFP. Proposals will not be accepted after the designated time and date. Any proposal received late will be returned to the responder unopened, if possible.
6. If a mistake is made or discovered during or after the County's review of proposals, the County reserves the right to determine which party made the mistake and whether the mistake is material and, after these determinations, the County, in its sole reasonable discretion, shall decide whether to accept or reject the proposal. No advantage shall be taken by any party of manifest clerical errors or omissions in any proposal. Responders shall notify the County immediately of any errors or omissions that are encountered.
7. Any item which does not meet all of the terms, conditions, or specifications of this package must be clearly indicated in the exceptions section of the Proposal Reply Form. It may also be on a separate sheet of paper and returned with the proposal.
8. The County shall not reimburse any responder for any cost incurred in preparing a proposal or attending equipment demonstrations, inspections, pre-proposal conferences, or interviews.
9. Any amplification, clarification, explanation, interpretation, or correction of a response shall be made only by written addendum, and a copy of the addendum shall be mailed or delivered to

each person receiving an RFP. The County is not responsible for any amplification, clarification, explanation, interpretation or correction of a proposal not contained in written addenda.

10. Proposals by corporations shall be executed in the corporate name by the president or a vice-president (or a corporate officer accompanied by evidence of authority to sign), and the corporate seal shall be affixed and attested by the secretary or an assistant secretary. The corporate address and state of incorporation shall be shown. Proposals submitted by partnerships shall be executed in the partnership name and signed by a partner, and the legal address of the partnership shall be shown. Proposals submitted by limited liability companies shall be executed in the company's name and signed by a member, and the legal address of the company shall be shown. Names and titles shall be typed or printed below each signature.
11. **Morgan County may grant a 5% preference to local businesses. A local business shall be a business which maintains a physical place of business in Morgan County.**
12. No proposal shall include federal excise taxes or state or local sales or use taxes.
13. Each proposal shall include a statement of standard warranty of the manufacturer if applicable.
14. Any response received as a result of this request is prepared at the responder's expense and becomes County property. Proposals are public records under Colorado Open Records Act. If responder considers any information confidential, responders shall mark such information as "Confidential".
15. By submitting a proposal, the responder acknowledges that (a) the preparation of the proposal, and other quotations herein contained, does not obligate the County in any way;; (b) all aspect of the RFP and project are understood; and (c) the responder has the ability to deliver the product/equipment/service as specified herein in accordance with the RFP.
16. No proposal may be withdrawn for a period of sixty (60) days after the deadline for proposals.
17. The County reserves the right, if it deems such action to be in its best interests, to reject any and all proposals, or to waive any irregularities or informalities therein. The County may also accept specific components or schedules of an overall proposal and reject other components or schedules. Any incomplete, false, or misleading information provided by any responder shall be grounds for rejection of the proposal. If proposals are rejected, the County further reserves the right to investigate and accept the next best proposal in order of ranking, or to reject all proposals and re-solicit for additional proposals.
18. The County reserves the right to determine, in its sole reasonable discretion, whether any proposal meets the needs or purposes intended and is within the approved budget. The County does not base its award on price alone. Other factors considered, depending on the needs of the County and the scope of the RFP, may include: quality of product; past experience with the responder or any subcontractors, consultants, products or suppliers; qualifications of the responder and/or subcontractors or suppliers; services offered; warranties; maintenance considerations; long-range costs; delivery; and similar conditions. The County reserves the right

to conduct such investigations as it deems necessary to assist in the evaluation of any proposal to establish the experience, responsibility, reliability, references, reputation, qualifications, or financial ability of any responder, manufacturer or supplier. The purpose of such investigation is to satisfy the County that the responder can supply the specified product/service and to perform the necessary warranty and product support in accordance with the RFP in the prescribed manner and time.

19. In the event of any claim, suit, or demand which may result from any proposal, or the award of any contract as a result of submission of a proposal, Colorado law shall govern any such claim, suit, or demand and the rights and duties of the parties.

Specific Project Requirements

1. It is the responsibility of the successful responder to obtain all the necessary permits, accesses and permissions required to complete all projects outlined in this RFP packet. (Examples: access/permits required for railroad right of ways, access/permits and traffic control requirements for state highway right of ways, permissions of landowners for access/staging/storing equipment, materials and supplies, etc.
2. Successful responder is responsible for all traffic control, including traffic control plan, devices, personnel and implementation. All costs associated with traffic control shall be included in per ton/lump sum pricing of laid material. No additional charges will be allowed.
3. Mobilization and setup costs shall be included in per ton/lump sum pricing of laid material. No additional charges for mobilization and setup will be allowed.
4. All work to conform to Colorado Department of Transportation 2023 Standard Specifications or Current Revisions.
5. All asphalt materials to conform to Colorado Department of Transportation 2023 Standard Specifications or Current Revisions. The use of recycled shingles (RAS) is not allowed. If shingles are detected in the mat, it is subject to removal and replacement and contract will terminate immediately.
6. All Tack Coat materials must conform to Colorado Department of Transportation 2023 Standard Specifications or Current Revisions.
7. Successful responder shall be responsible for quality control and testing on this project. All testing and other required services must be included in the proposed price. Said testing shall be accompanied by county personnel. Any additional testing Morgan County deems necessary will be at Morgan County's expense, utilizing an independent firm of Morgan County's choosing.
8. Morgan County Government will be responsible for completion of all shoulder work after asphalt is laid.
9. All contract work must be completed on or before October 31, 2025.
10. With the exception of lump sum schedules, payments will be made based on certified weight tickets of actual asphalt laid at a price per ton calculation of appropriate project schedule. Award tabulation will be based on Plan Quantities. Plan Quantities are estimates only for all schedules.
11. An approved "Change Order" will be required before payment will be made in excess of the estimated Plan Quantities.
12. It is Morgan County's intent to complete all the projects listed in the schedules in the 2025 year, however; due to Budget constraints Morgan County reserves the right to adjust or remove any schedule from this RFP it deems necessary to meet budget guidelines.
13. Vendor's may contact John Goodman, Morgan County Road Supervisor at 970-542-3561 to set up an appointment to tour the work sites.
14. There is no engineer's estimates for these projects.

PROPOSAL REPLY FORM

Name and Address of Responder:

Name of Company _____

Address of Company _____

City _____ State _____ Zip Code _____

Phone Number _____ Fax Number _____

Representative (Print Name) _____ Title _____

Signature _____

Email _____

Summary of Project Schedules:

Schedules	Schedule Total	Schedules	Schedule Total
Schedule 1	\$ _____	Schedule 5	\$ _____
Schedule 2	\$ _____	Schedule 6	\$ _____
Schedule 3	\$ _____	Schedule 7	\$ _____
Schedule 4	\$ _____		

Total All Schedules \$ _____

*Attach a separate sheet outlining any exceptions to this bid. *If Any*

**Attach a separate sheet outlining any warranty for the work completed. *If Any*

PROJECT SCHEDULE 1
"2025-0320-001 ASPHALT PAVING PROJECTS"

Project: County Road 24 from Interstate 76 North ROW Line to County Road W
Asphalt Type: Overlay, 3 Inches, Completed in Two Courses
Measurements: Length of Road to be paved 13,266 feet, Road Width 24 Feet, Pavement Thickness 3 Inches.

Scope of Work

1. All items outlined in the Specific Project Requirements section are required in the scope of work, plus the following:
2. Prior to paving, repair culvert cut on Road T at the intersection of Road 24. Repair is to include excavating 3 inches of material from between the existing 10 foot by 24 foot asphalt cut, then the cut shall be patched with 3 inches of new asphalt level with existing roadway.
3. Prior to paving, repair culvert cut on Road 24 at the intersection of Road T.5/T.9. Repair is to include excavating 3 inches of material from between the existing 10 foot by 24 foot asphalt cut, then the cut shall be patched with 3 inches of new asphalt level with existing roadway.
4. Prior to paving, repair existing 6 foot by 28 foot asphalt cut at each end of bridge abutments. Repair is to include excavating 3 inches of material from between the existing 6 foot by 28 foot asphalt cut, then the cut shall be patched with 3 inches of new asphalt level with existing roadway and bridge deck.
5. Prior to paving, add a taper to the existing roadway, starting at the southeast corner of the abutment wall at 4 feet in width from the existing pavement line and head south for 250 feet to a width of 0 feet from existing pavement line. The work is to include excavating 3 inches of material from the aforementioned line and paving with 3 inches of new asphalt level with the existing roadway.
6. Prior to paving, add a taper to the existing roadway, starting at the northeast corner of the abutment wall at 4 feet in width from the existing pavement line and head north for 250 feet to a width of 0 feet from existing pavement line. The work is to include excavating 3 inches of material from the aforementioned line and paving with 3 inches of new asphalt level with the existing roadway.
7. Prior to paving, add a taper to the existing roadway, starting at the northwest corner of the abutment wall at 1 feet in width from the existing pavement line and head north for 250 feet to a width of 0 feet from existing pavement line. The work is to include excavating 3 inches of material from the aforementioned line and paving with 3 inches of new asphalt level with the existing roadway.
8. Prior to paving, add a taper to the existing roadway, starting at the southwest corner of the abutment wall at 1 feet in width from the existing pavement line and head south for 250 feet to a width of 0 feet from existing pavement line. The work is to include excavating 3 inches of material from the aforementioned line and paving with 3 inches of new asphalt level with the existing roadway.

9. Tie joints to all existing pavement shall be milled to a depth corresponding to the finished mat thickness listed on the project schedule. The taper shall span at least 15 feet in length from the joint for smooth transition.
 - Locations: On Road 24 at the north right of way Line of Interstate Highway 76
 - On Road T, approximately 50 feet east of the intersection of Road 24
 - On Road 24, north of the intersection of Road T at previous new asphalt line
 - On Road 24, north of the intersection of Road T.5/T.9 at previous new asphalt line
 - On Road 24, north of the intersection of Road W
 - On Road 24, at the intersection of Road W, on the east and west side of the intersection next to the grated culverts.
10. All asphalt repair locations will be paved over with the 3 inch final overlay completed in two courses.
11. All asphalt laid at tie joints shall be feathered out to create smooth transitions.
12. All intersecting paved roads will have the new asphalt feathered into them and corresponding radius for smooth transition.
13. At the intersection of Road 24 and Road W, new asphalt, 6 inches in depth, completed in two courses shall be laid for a distance of 50 feet from the grated culverts, on Road W, on either side of the intersection. Preparation of the gravel road shall be completed by Morgan County at this location and coordinated with the successful responder.
14. All intersecting gravel roads shall have the new asphalt feathered into them for the full width of the intersecting road and a length of at least 5 feet from the edge of the new asphalt.
15. All intersecting driveway accesses shall have new asphalt feathered into them as appropriate to allow accesses to pavement surface without causing damage to the pavement edge.
16. A tack coat shall be applied in between each new course of asphalt.
17. All asphalt material shall be compacted to the appropriate levels according to the Current CDOT Specifications.
18. Any other work required to complete asphalt paving must conform to Current CDOT Specifications.
19. Use of a paper joint at the end of each day is required for clean start joint on following day for this schedule.

Asphalt Specifications and Plan Quantities

Segment	Product	Estimate Quantity in Tons
3" Overlay – Completed in 2 Courses	Asphalt, Grade SX with a Maximum 23% binder replacement, PG 64-22 Binder, 75 Gyraton Must Meet Current CDOT Specifications	6,400
Tack Coat	Must Meet Current CDOT Specifications	No Estimate Required Before Each New Pavement Course

**Propo
s
al
for
this**

Schedule

**Two Courses
3 Inches Grade SX**

Price per Ton: \$ _____

Estimated Tons X__6,400_____

Total This Schedule Based on Plan Quantities: \$ _____

Signature of Responder: _____ Date: _____

PROJECT SCHEDULE 2
"2025-0320-001 ASPHALT PAVING PROJECTS"

Project: County Road W from County Road 16 to County Road 15
Asphalt Type: New Pavement, 6 Inches, Completed in Two Courses
Measurements: Road length 5315 feet, Road Width 26 feet, Pavement Thickness 6 Inches.

Scope of Work

Morgan County work force will complete all sub grade and prep work needed for this project. Prep work to include; repair of any damaged section(s), compaction, watering, final grading and shouldering of the sub grade and preparation of the sub grade at end of existing pavement at County Road 16. After asphalt is in place, Morgan County will complete the fill on the shoulder of the new pavement.

Contractor shall be responsible for all the following:

1. All items outlined in the Specific Project Requirements section are required in the scope of work, plus the following:
2. Contractor will coordinate with Morgan County to ensure sub grade is acceptable prior to the lay down of new asphalt.
3. Tie joints to all existing pavement shall be milled to a depth corresponding to the finished mat thickness listed on the project schedule. The taper shall span at least 15 feet in length from the joint for smooth transition.
Locations: On Road W at the existing end of pavement at intersection of Road 16
4. All asphalt laid at tie joints shall be feathered out to create smooth transitions.
5. All intersecting gravel roads shall have the new asphalt feathered into them for the full width of the intersecting road and a length of at least 5 feet from the edge of the new asphalt.
6. All intersecting driveway accesses shall have new asphalt feathered into them as appropriate to allow accesses to pavement surface without causing damage to the pavement edge.
7. A tack coat shall be applied in between each new course of asphalt.
8. Asphalt shall be laid in two courses. The bottom course shall be 4 inches in thickness and the top course shall be 2 inches in thickness.
9. All asphalt material shall be compacted to the appropriate levels according to the Current CDOT Specifications.
10. Any other work required to complete asphalt paving must conform to Current CDOT Specifications.

11. Use of a paper joint at the end of each day is required for clean start joint on following day for this schedule.

Asphalt Specifications and Plan Quantities

Segment	Product	Estimate Quantity in Tons
New Asphalt 4 Inch Bottom Course	Asphalt, Grade SG with a Maximum 23% binder replacement, PG 64-22 Binder, 75 Gyration Must Meet Current CDOT Specifications	3,500
New Asphalt 2 Inch Top Course	Asphalt, Grade SX with a Maximum 23% binder replacement, PG 64-22 Binder, 75 Gyration Must Meet Current CDOT Specifications	1,800
Tack Coat	Must Meet Current CDOT Specifications	No Estimate Required Before Each New Pavement Course

Bid for this Schedule

**Bottom Course
4 Inches Grade SG**

**Top Course
2 Inch Grade SX**

Price Per Ton: \$ _____

Price Per Ton: \$ _____

Estimated Tons X 3,500

Estimated Tons X 1,800

Total Bid Grade SG \$ _____

Total Bid Grade SX \$ _____

Total Bid This Schedule Based on Plan Quantities: \$ _____

Signature of Bidder: _____ **Date:** _____

PROJECT SCHEDULE 3

"2025-0320-001 ASPHALT PAVING PROJECTS"

Project: Patch a culvert cut on County Road 12 South of the intersection of County Road Q

Scope of Work

1. All items outlined in the Specific Project Requirements section are required in the scope of work, plus the following:
2. Successful Responder will complete all prep work including excavating 6 inches of material from the area between the asphalt cuts for this location prior to patching.
3. The existing 10' x 24' culvert cut shall be patched with 6 inches of asphalt laid in two courses bringing the level up to top edge of the existing pavement.
4. A tack coat shall be applied in between each new course of asphalt.
5. All asphalt material shall be compacted to the appropriate levels according to the Current CDOT Specifications.
6. Any other work required to complete asphalt paving must conform to Current CDOT Specifications.
7. Lump Sum price shall include all the above detailed items. No additional costs may be added.

Asphalt Specifications and Plan Quantities

Segment	Product	Estimate Quantity in Tons
6" Patch Completed in 2 Courses	Asphalt, Grade SX with a Maximum 23% binder replacement, PG 64-22 Binder, 75 Gyrations Must Meet Current CDOT Specifications	10
Tack Coat	Must Meet Current CDOT Specifications	No Estimate Required Before Each New Pavement Course

Proposal for this Schedule

edule

Lump Sum Proposal for this Project Schedule: \$ _____

Signature of Responder: _____ **Date:** _____

PROJECT SCHEDULE 4
"2025-0320-001 ASPHALT PAVING PROJECTS"

Project: Patch a culvert cut on County Road 16 at the intersection of County Road Q

Scope of Work

1. All items outlined in the Specific Project Requirements section are required in the scope of work, plus the following:
2. Successful Responder will complete all prep work including excavating 6 inches of material from the area between the asphalt cuts for this location prior to patching.
3. The existing 22' x 26' culvert cut shall be patched with 6 inches of asphalt laid in two courses bringing the level up to top edge of the existing pavement.
4. Prep, repair and overlay the damage to the intersection radius with asphalt.
5. A tack coat shall be applied in between each new course of asphalt.
6. All asphalt material shall be compacted to the appropriate levels according to the Current CDOT Specifications.
7. Any other work required to complete asphalt paving must conform to Current CDOT Specifications.
8. Lump Sum price shall include all the above detailed items. No additional costs may be added.

Asphalt Specifications and Plan Quantities

Segment	Product	Estimate Quantity in Tons
6" Patch Completed in 2 Courses	Asphalt, Grade SX with a Maximum 23% binder replacement, PG 64-22 Binder, 75 Gyrations Must Meet Current CDOT Specifications	30
Tack Coat	Must Meet Current CDOT Specifications	No Estimate Required Before Each New Pavement Course

Proposal for this Schedule

chedule

Lump Sum Proposal for this Project Schedule: \$ _____

Signature of Responder: _____ Date: _____

PROJECT SCHEDULE 5
 "2025-0320-001 ASPHALT PAVING PROJECTS"

Project: Patch a culvert cut on County Road P between County Road 19 and County Road 20

Scope of Work

1. All items outlined in the Specific Project Requirements section are required in the scope of work, plus the following:
2. Successful Responder will complete all prep work including excavating 6 inches of material from the area between the asphalt cuts for this location prior to patching.
3. The existing 10' x 24' culvert cut shall be patched with 6 inches of asphalt laid in two courses bringing the level up to top edge of the existing pavement.
4. A tack coat shall be applied in between each new course of asphalt.
5. All asphalt material shall be compacted to the appropriate levels according to the Current CDOT Specifications.
6. Any other work required to complete asphalt paving must conform to Current CDOT Specifications.
7. Lump Sum price shall include all the above detailed items. No additional costs may be added.

Asphalt Specifications and Plan Quantities

Segment	Product	Estimate Quantity in Tons
---------	---------	---------------------------

6" Patch Completed in 2 Courses	Asphalt, Grade SX with a Maximum 23% binder replacement, PG 64-22 Binder, 75 Gyration Must Meet Current CDOT Specifications	10
Tack Coat	Must Meet Current CDOT Specifications	No Estimate Required Before Each New Pavement Course

**Propo
s
al
for
this**

Schedule

Lump Sum Proposal for this Project Schedule: \$ _____

Signature of Responder: _____ **Date:** _____

PROJECT SCHEDULE 6
"2025-0320-001 ASPHALT PAVING PROJECTS"

Project: Patch a culvert cut on County Road W between County Road 30 and County Road 31, East Culvert Cut

Scope of Work

1. All items outlined in the Specific Project Requirements section are required in the scope of work, plus the following:
2. Successful Responder will complete all prep work including excavating 6 inches of material from the area between the asphalt cuts for this location prior to patching.
3. The existing 10' x 24' culvert cut shall be patched with 6 inches of asphalt laid in two courses bringing the level up to top edge of the existing pavement.
4. A tack coat shall be applied in between each new course of asphalt.
5. All asphalt material shall be compacted to the appropriate levels according to the Current CDOT Specifications.
6. Any other work required to complete asphalt paving must conform to Current CDOT Specifications.
7. Lump Sum price shall include all the above detailed items. No additional costs may be added.

Asphalt Specifications and Plan Quantities

Segment	Product	Estimate Quantity in Tons
----------------	----------------	----------------------------------

6" Patch Completed in 2 Courses	Asphalt, Grade SX with a Maximum 23% binder replacement, PG 64-22 Binder, 75 Gyration Must Meet Current CDOT Specifications	10
Tack Coat	Must Meet Current CDOT Specifications	No Estimate Required Before Each New Pavement Course

**Propo
s
al
for
this**

Schedule

Lump Sum Proposal for this Project Schedule: \$ _____

Signature of Responder: _____ **Date:** _____

PROJECT SCHEDULE 7
"2025-0320-001 ASPHALT PAVING PROJECTS"

Project: Patch a culvert cut on County Road W between County Road 30 and County Road 31, West Culvert Cut

Scope of Work

1. All items outlined in the Specific Project Requirements section are required in the scope of work, plus the following:
2. Successful Responder will complete all prep work including excavating 6 inches of material from the area between the asphalt cuts for this location prior to patching.
3. The existing 10' x 24' culvert cut shall be patched with 6 inches of asphalt laid in two courses bringing the level up to top edge of the existing pavement.
4. A tack coat shall be applied in between each new course of asphalt.
5. All asphalt material shall be compacted to the appropriate levels according to the Current CDOT Specifications.
6. Any other work required to complete asphalt paving must conform to Current CDOT Specifications.
7. Lump Sum price shall include all the above detailed items. No additional costs may be added.

Asphalt Specifications and Plan Quantities

Segment	Product	Estimate Quantity in Tons
----------------	----------------	----------------------------------

6" Patch Completed in 2 Courses	Asphalt, Grade SX with a Maximum 23% binder replacement, PG 64-22 Binder, 75 Gyrations Must Meet Current CDOT Specifications	10
Tack Coat	Must Meet Current CDOT Specifications	No Estimate Required Before Each New Pavement Course

Proposal for this

Schedule

Lump Sum Proposal for this Project Schedule: \$ _____

Signature of Responder: _____ **Date:** _____

REFERENCES

Please provide a list of at least three references for work completed by your company over the last three years.

Reference 1. Contact Information

Company or Entity _____
Contact Person _____
Contact Address _____
Contact City/State/Zip _____
Contact Phone Number _____
Contact E-Mail Address _____

Year Work was performed _____
Type of Work Completed _____

Location of Completed Work _____

Size & Scope of Work:
Up to \$100,000 _____
\$100,000-\$250,000 _____
\$250,000-\$500,000 _____
\$500,000-\$1,000,000 _____
Over \$1,000,000 _____

Reference 2. Contact Information

Company or Entity _____
Contact Person _____
Contact Address _____
Contact City/State/Zip _____
Contact Phone Number _____
Contact E-Mail Address _____

Year Work was performed _____
Type of Work Completed _____

Location of Completed Work _____

Size & Scope of Work:
Up to \$100,000 _____
\$100,000-\$250,000 _____
\$250,000-\$500,000 _____
\$500,000-\$1,000,000 _____
Over \$1,000,000 _____

REFERENCES

Reference 3. Contact Information

Company or Entity _____
Contact Person _____
Contact Address _____

Contact City/State/Zip _____
Contact Phone Number _____
Contact E-Mail Address _____

Year Work was performed _____
Type of Work Completed _____

Location of Completed Work _____

Size & Scope of Work:
Up to \$100,000 _____
\$100,000-\$250,000 _____
\$250,000-\$500,000 _____
\$500,000-\$1,000,000 _____
Over \$1,000,000 _____

Reference 4. Contact Information

Company or Entity _____
Contact Person _____
Contact Address _____
Contact City/State/Zip _____
Contact Phone Number _____
Contact E-Mail Address _____

Year Work was performed _____
Type of Work Completed _____
Location of Completed Work _____

Size & Scope of Work:
Up to \$100,000 _____
\$100,000-\$250,000 _____
\$250,000-\$500,000 _____
\$500,000-\$1,000,000 _____
Over \$1,000,000 _____

Attachment A

**Morgan County Government
GPS Coordinates for Project Sites**

The following are the GPS Coordinates for each bid schedule.

The coordinates listed are not the actual start and stop points for the actual work, These are reference points to be used to take a virtual tour of the work sites and their locations.

All coordinates are in decimal degrees format.

Bid Schedule	Road		Latitude	Longitude
Bid Schedule 1	Overlay on County Road 24 from I76 North Right of Way Line to County Road W <i>(Skip Section Completed in 2024 from County Road T to County Road T.5)</i>	Start At	40.268793	-103.697029
		End At	40.319439	-103.696390
Bid Schedule 2	New Paving (Six Inch) on County Road W from County Road 16 to County Road 15	Start At	40.319615	-103.848018
		End At	40.319648	-103.867063
Bid Schedule 3	Culvert Cut on County Road 12 at the Intersection of County Road Q	Start At	40.231973	-103.924285
Bid Schedule 4	Culvert Cut on County Road 16 at the Intersection of County Road Q	Start At	40.232358	-103.849058
Bid Schedule 5	Culvert Cut on County Road P Between County Road 19 and County Road 20	Start At	40.217777	-103.775186
Bid Schedule 6	Culvert Cut on County Road W Between County Road 30 and County Road 31 (East Cut)	Start At	40.320159	-103.574993
Bid Schedule 7	Culvert Cut on County Road W Between County Road 30 and County Road 31 (West Cut)	Start At	40.320133	-103.580350

ATTACHMENT B

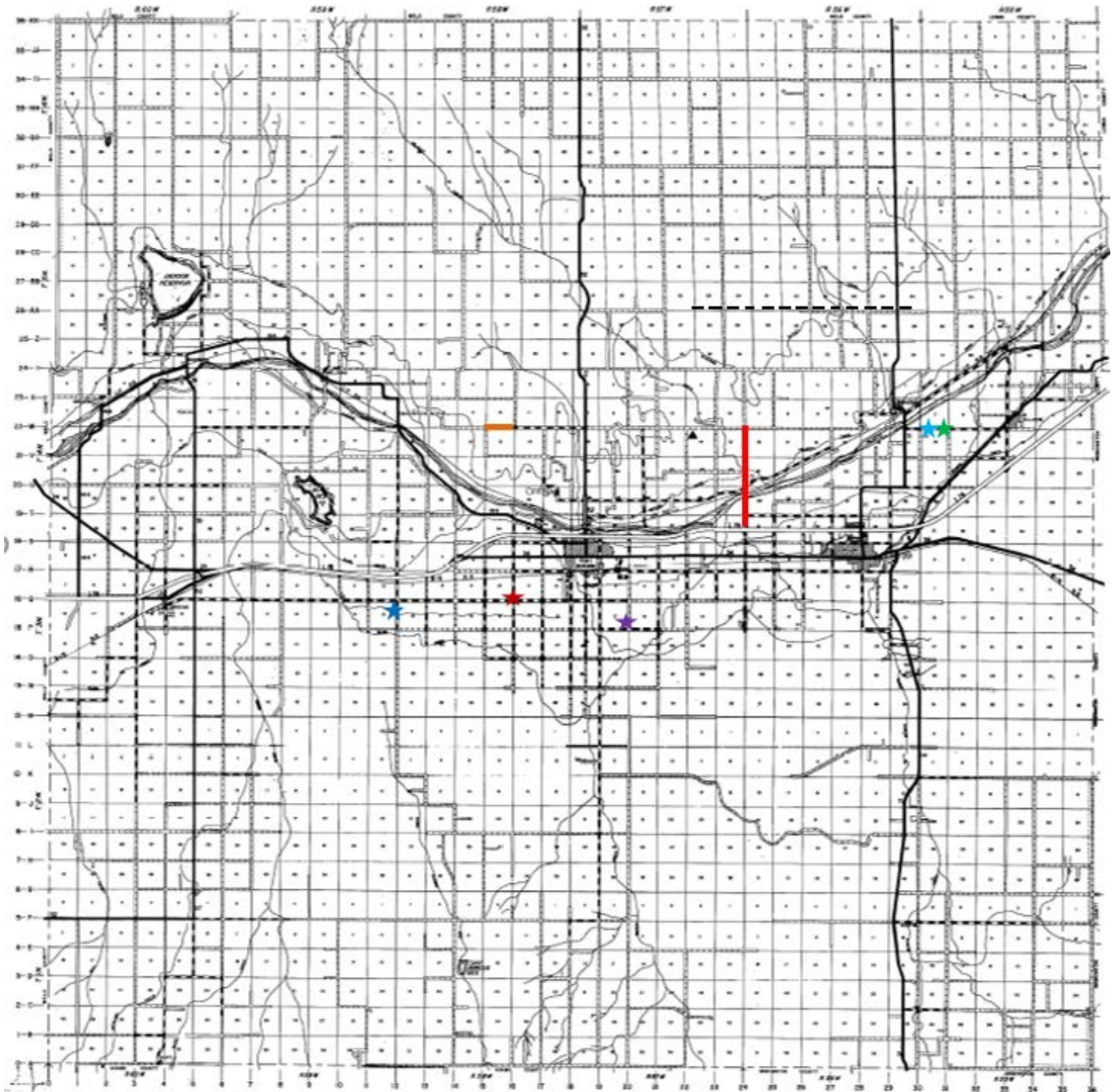

- █ Bid Schedule 1 – Overlay County Road 24 from I76 North Right of Way Line to County Road W (Skip Section completed in 2024 from County Road T to County Road T.5)
- █ Bid Schedule 2 – New Pavement County Road W from County Road 16 to County Road 15 (Six inches in depth)
- ★ Bid Schedule 3 – Repair Culvert Cut on County Road 12 at the intersection of County Road Q
- ★ Bid Schedule 4 – Repair Culvert Cut on County Road 16 at the Intersection of County Road Q
- ★ Bid Schedule 5 – Repair Culvert Cut on County Road P between County Road 19 and County Road 20
- ★ Bid Schedule 6 – Repair Culvert Cut on County Road W between County Road 30 and County Road 31 (East Cut)
- ★ Bid Schedule 7 – Repair Culvert Cut on County Road W between County Road 30 and County Road 31 (West Cut)