



MORGAN COUNTY PLANNING,  
ZONING & BUILDING DEPT.  
231 Ensign, P.O. Box 596  
Fort Morgan, Colorado 80701  
PHONE (970)542-3526  
FAX (970)542-3509

EMAIL [permits\\_licensing@co.morgan.co.us](mailto:permits_licensing@co.morgan.co.us)

PERMIT # \_\_\_\_\_ - \_\_\_\_\_

Date Received _____/_____/_____	Received By _____
App Fee \$ _____	Ck/CC #: _____ Paid _____/_____/_____
100 Year Floodplain <u>Y/N</u>	Taxes Current <u>Y/N</u>

## BUILDING PERMIT APPLICATION

### Landowner MUST Sign Application and Right to Farm Policy

PERMIT TYPE: New Building: \_\_\_\_\_ Remodel: \_\_\_\_\_ Addition: \_\_\_\_\_ Manufactured Home: \_\_\_\_\_ Windows/Doors/Siding: \_\_\_\_\_  
PROPOSED USE: Residential: \_\_\_\_\_ Commercial: \_\_\_\_\_ Agricultural: \_\_\_\_\_ Other: \_\_\_\_\_

#### LANDOWNER

Name \_\_\_\_\_  
Address \_\_\_\_\_  
\_\_\_\_\_  
Phone \_\_\_\_\_  
Email \_\_\_\_\_

#### JOB SITE ADDRESS & LEGAL DESCRIPTION

Parcel # \_\_\_\_\_  
S: \_\_\_\_\_ T: \_\_\_\_\_ R: \_\_\_\_\_ Zone District \_\_\_\_\_  
Subdivision \_\_\_\_\_ Lot #(s) \_\_\_\_\_  
Property Size \_\_\_\_\_ (in sq. ft. or acres)

**CONTRACTOR** \*Contractor MUST carry a current Morgan County Contractor's License

Contractor Name \_\_\_\_\_ -If Homeowner is Contractor- write **SELF**

Phone ( ) \_\_\_\_\_ Email \_\_\_\_\_

#### PROJECT DESCRIPTION

Cost of Project \$ \_\_\_\_\_ Purpose of Structure \_\_\_\_\_

Project Dimensions: Length \_\_\_\_\_ Width \_\_\_\_\_ Height \_\_\_\_\_

Number of Bedrooms \_\_\_\_\_ Number of Bathrooms: Full \_\_\_\_\_  $\frac{3}{4}$  \_\_\_\_\_  $\frac{1}{2}$  \_\_\_\_\_  
(Please Note: Full baths contain tub & shower or combo,  $\frac{3}{4}$  baths contain **only** shower)

#### SQUARE FOOTAGE

Main Floor \_\_\_\_\_ Additional Upper Floors \_\_\_\_\_ Garage Square Footage \_\_\_\_\_

Basement \_\_\_\_\_ ☐ Finished ☐ Unfinished Crawlspc \_\_\_\_\_

**Required Setbacks:** Front \_\_\_\_\_ Side L \_\_\_\_\_ Side R \_\_\_\_\_ Rear \_\_\_\_\_

**Actual Setbacks:** Front \_\_\_\_\_ Side L \_\_\_\_\_ Side R \_\_\_\_\_ Rear \_\_\_\_\_

Permit must be issued **PRIOR** to moving any dirt, or beginning construction.

**SEE REQUIRED ATTACHMENT LIST ON BACK OF THIS PAGE.**

**INCOMPLETE APPLICATIONS WILL NOT BE ACCEPTED OR PROCESSED**

## BUILDING PERMIT APPLICATION ATTACHMENT LIST

*Additional information may be required by staff*

### **Fee:**

☐ Non-Refundable Application Fee

*\*Fee may be subject to change per section 2-160 of Morgan County Zoning Regulations*

### **Utilities/Access:**

☐ Water-must prove quality, quantity, & reliability

(Quality Water Contract or current Permit from Colorado Department of Natural Resources)

<https://dwr.state.co.us/Tools/WellPermits>

☐ Sewer (Septic Permit, Will Serve Letter from NCHD or proof of other public system)

☐ Driveway Permit from CDOT or Morgan County Road and Bridge (new driveways)

☐ Ditch Company- Proof of contact if there is a ditch on or next to your property

☐ Architecture Control Approval (if applicable)

### **Site Map & Plans:**

☐ Site Plan must show all existing/proposed structures and setbacks from all property lines as per Morgan County Zoning Regulations, Section 2-410

☐ Detailed Construction Plans (**ELECTRONIC HIGHLY ENCOURAGED**)

☐ **Drainage/Run-Off Control Plan** may be required prior to approval if the Planning Administrator determines that the use or building meets one of the following criteria: (see Morgan County Zoning Regulations 3-130(G))

(1) The accessory use or building may have a drainage impact on adjacent properties;

(2) The accessory use or building may have a drainage impact on adjacent right of ways;

(3) The accessory structure is 5000 square feet or larger.

### **Technical:**

☐ Right to Farm Policy **signed by Landowner** (attached)

☐ Technical Specifications (*include only if replacing windows/doors/siding*)

☐ Windows Replacement: Like for Like? ☐ Yes ☐ No *If **no**, attach statement explaining*

☐ Additional Information required by staff: \_\_\_\_\_



**Don't Forget to Also Get Your Colorado State Permits for Plumbing & Electric!**

<https://dpo.colorado.gov/EandP/Permits>

**Certificate of Occupancy will NOT be Issued until AFTER the Project Passes ALL Final Inspections from the State!!!**

**Landowner must sign application on the next page!**

## **Landowner MUST Sign Application**

Landowner agrees to contract the project in accordance to the plans and specifications submitted herewith and in strict compliance with the provisions of the Morgan County Zoning Regulations and the Morgan County Building Code. Buildings **MUST** conform to the submitted and approved plans. Any changes of plans or layout must be approved prior to the changes being made.

**Any change in the use or occupancy MUST be approved PRIOR to commencement of construction.**

The applicant, his agents and employees of, shall comply with all the rules, regulations and requirements of the County Zoning Regulations and Building Codes governing all aspects of the above proposed work for which the permit is granted. The County or its agents are authorized to order the immediate cessation of construction, at any time, if a violation of the codes or regulations appears to have occurred. Issuance of a building or zoning permit does not guarantee your project is in compliance with covenants that may be in place on your property. Landowner is notified that any past, existing or future drainage associated with this property is the responsibility of the landowner and not that of Morgan County.

Construction not commenced within 180 days of permit issuance voids this permit. Cessation of work for periods of 180 continuous days shall also void this permit, unless an extension is requested. Morgan County and any of its contractors are not liable for workmanship. Permits are NOT transferable.

**Signing this application gives the Building Inspector and/or his agent express permission to enter permitted property for the purpose of conducting inspections as required by Morgan County Zoning Regulations and Morgan County Building Code.**

Additional fees may be charged if this inspection is not conducted prior to start of construction. -See Morgan County Zoning Regulations 1-315

Failure to comply with inspection may result in additional fees and/or denial of a Morgan County Contractor's license.

Applications completed for properties not current in their property taxes will **not** be accepted.

**Violation of any of the codes and applicable regulations may result in the revocation of this permit.**

Landowner Signature: \_\_\_\_\_ Date: \_\_\_\_\_

Contractor Signature: \_\_\_\_\_ Date: \_\_\_\_\_

**SITE MUST BE STAKED AND READY FOR INSPECTION AT TIME APPLICATION IS SUBMITTED.**

## MORGAN COUNTY RIGHT TO FARM POLICY / NOTICE

Morgan County is one of the most productive agricultural counties in Colorado. Ranching, farming, animal feeding, and all other manner of agricultural activities and operations in Morgan County are integral and necessary elements of the continued vitality of the county's economy, culture, landscape and lifestyle. Morgan County specifically recognizes the importance of agricultural operations as necessary and worthy of recognition and protection.

Landowners, residents and visitors must be prepared to accept as normal the effects of agriculture and rural living. These may include noise from tractors, equipment, and aerial spraying sometimes at night or in the early morning; dust from animal pens, field work, harvesting, and gravel roads; odor from animal confinement operations, silage and manure; smoke from ditch burning; flies and mosquitoes; the use of pesticides and fertilizers, including aerial spraying; and movement of livestock or machinery on public roads. Under the provisions of the State of Colorado's "Right to Farm" law (Section 35-3.5-101 and following, C.R.S.), all normal and non-negligent agricultural operations may not be considered nuisances.

Also public services in a rural area are not at the same level as in an urban or suburban setting. Road maintenance may be at a lower level, mail delivery may not be as frequent, utility services may be nonexistent or subject to interruption, law enforcement, fire protection and ambulance service will have considerably longer response times, snow may not be removed from county roads for several days after a major snow storm. First priority for snow removal is that school bus routes are normally cleared first.

Children are exposed to different hazards in a rural setting than they are in an urban or suburban area. Farm and oilfield equipment, ponds, and irrigation ditches, electrical service to pumps and oil field operations, high speed traffic, noxious weeds, livestock, and territorial farm dogs may present real threats to children. It is necessary that children's activities be properly supervised for both the protection of the children and protection of the farmer's livelihood.

All rural residents and property owners are encouraged to learn about their rights and responsibilities and to act as good neighbors and citizens of Morgan County. This includes but is not limited to obligations under Colorado State law and Morgan County Zoning Regulations regarding maintenance of fences, controlling weeds, keeping livestock and pets under control. There may be provisions of which you are unaware. For example, because Colorado is a Fence Law State, owners of property may be required to fence livestock out.

Information regarding these topics may be obtained from the Colorado State University Cooperative Extension Office, the County Planning and Zoning Department, and the County Attorney.

### RECEIPT AND STATEMENT OF UNDERSTANDING

I hereby certify that I have received, read, and understood the Morgan County Statement of Policy and Notice regarding Right to Farm.

I further state that I am aware that the conditions of living in an unincorporated area are different than living in a town or city and that the responsibilities of rural residents are different from urban or suburban residents. I understand that under Colorado law that a pre-existing, non-negligent agricultural operation may not be considered a public or private nuisance.

***To Be Signed by Landowner***

\_\_\_\_\_  
Signature

\_\_\_\_\_  
Date

\_\_\_\_\_  
Printed Name

\_\_\_\_\_  
Address

MORGAN COUNTY ROAD AND BRIDGE DEPARTMENT  
REQUEST FOR DRIVEWAY ACCESS LETTER

Requested By: Name: \_\_\_\_\_ Date: \_\_\_\_\_

Address: \_\_\_\_\_

City/State/Zip: \_\_\_\_\_

Phone: \_\_\_\_\_

Legal Description: \_\_\_\_\_

Present Driveway Location: \_\_\_\_\_

New Driveway Location: \_\_\_\_\_

If this letter is to be mailed to an address different from above indicate:

Name: \_\_\_\_\_

Address: \_\_\_\_\_

City/State/Zip: \_\_\_\_\_

Phone: \_\_\_\_\_

Submit this request to: Morgan County Road and Bridge Department :

Attn: James Rehn – Bridge Manager

17303 Co Rd S

P.O. Box 516

Fort Morgan, CO 80701

(970) 542-3560 Fax (970) 542-3569

---

**For Office Use Only**

Determination: \_\_\_\_\_

GPS Coordinates, Centerline of Driveway in relation to road: Latitude: \_\_\_\_\_

Longitude: \_\_\_\_\_

Maximum Width of Driveway: \_\_\_\_\_ Feet

Culvert Required: YES / NO If yes, Size: \_\_\_\_\_ Inch

Driveway Address Code: \_\_\_\_\_

Received by: \_\_\_\_\_ Date: \_\_\_\_\_

Completed by: \_\_\_\_\_ Date: \_\_\_\_\_

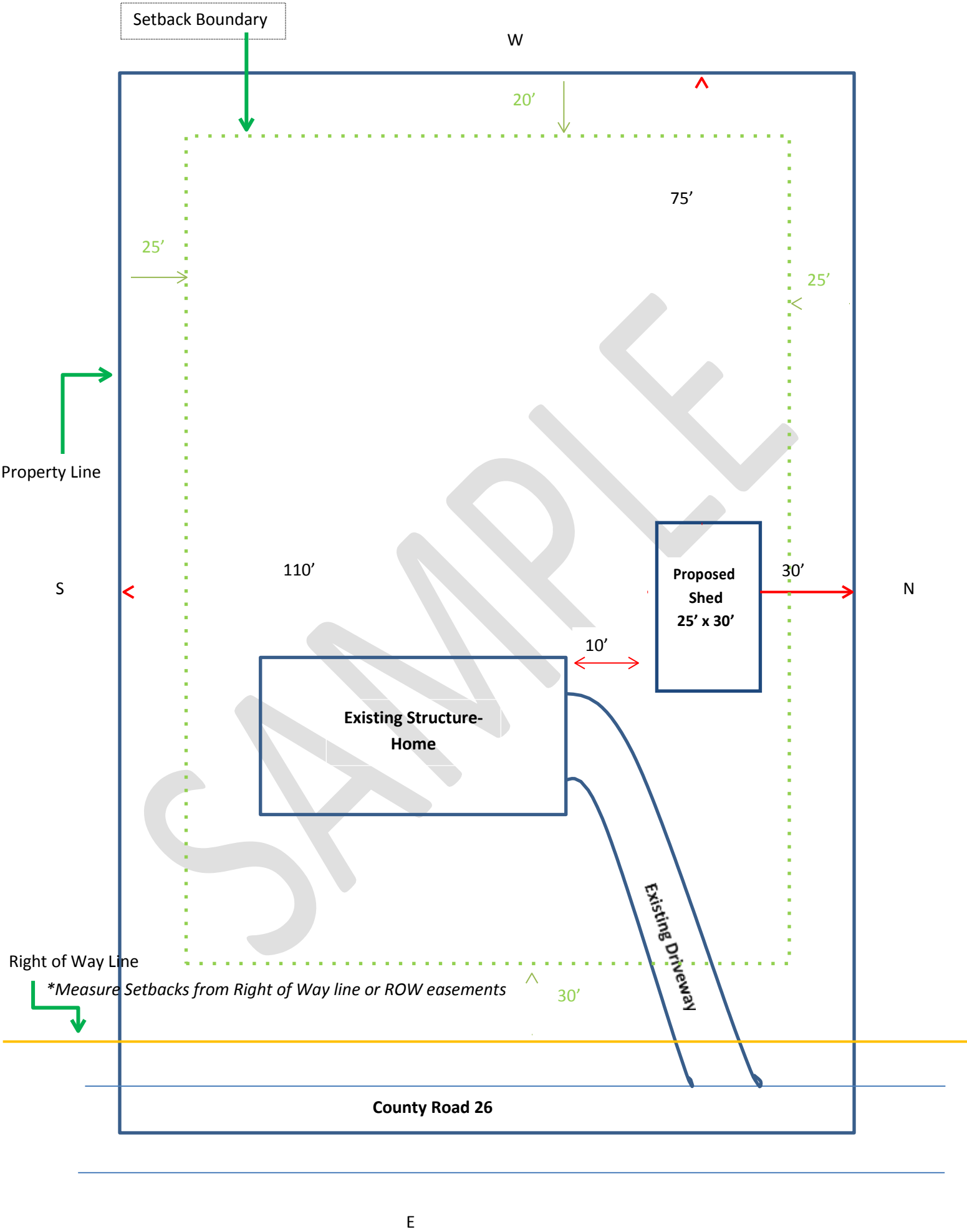



## Morgan County Energy Code Submittal Requirements

The Morgan County Building Department has adopted the 2006 International Energy Conservation Code effective July 1, 2008. Currently, Morgan County is under the 2003 International Residential Code. Chapter 11 of this code has been deleted and all reference to energy codes shall be that of the 2006 International Energy Conservation Code. The submittal requirements for residential energy compliance are outlined below as determined by the building department.

Above Ground Exterior Wall Insulation R Value \_\_\_\_\_ Min R-20

Ceiling Insulation R Value \_\_\_\_\_ Min R-38

Basement Wall Insulation R Value \_\_\_\_\_ Min R-10

Floor Insulation R Value \_\_\_\_\_ Min R-21

Crawl Space Wall Insulation R Value \_\_\_\_\_ Min R-20

Slab Perimeter R Value \_\_\_\_\_ Min R-9, 4 ft.

Over Garage Insulation if Under Living Area R Value \_\_\_\_\_ Min R-21

Window and Door U Factor \_\_\_\_\_ Max .35 SHGC Rating \_\_\_\_\_

Skylight U Factor \_\_\_\_\_ SHGC Rating \_\_\_\_\_

Siding R Value \_\_\_\_\_ (if any)

Weather Barrier \_\_\_\_\_ (Exterior) Vapor Barrier \_\_\_\_\_ (Interior)

Furnace Size and Efficiency \_\_\_\_\_

Calculation Method Used \_\_\_\_\_

Duct Work Design Calculation Method \_\_\_\_\_

Water Heater Size and Efficiency \_\_\_\_\_

Compact Fluorescent Light Bulbs \_\_\_\_\_