



**Question Set #1 received from Bidders and Responses on behalf of Morgan County
Posted 6.8.2021**

**Morgan County, Colorado
RFP 2021-0624-001 Emulsified Asphalt**

Question #1:

Pricing for emulsified asphalt is to include freight to project locations- can the County please provide either an average delivery point for this year's project or could you provide a list of individual project locations to serve as reference for freight pricing?

Answer #1

See attached

Morgan County Government

Road Department

2021 Chip Seal Plan

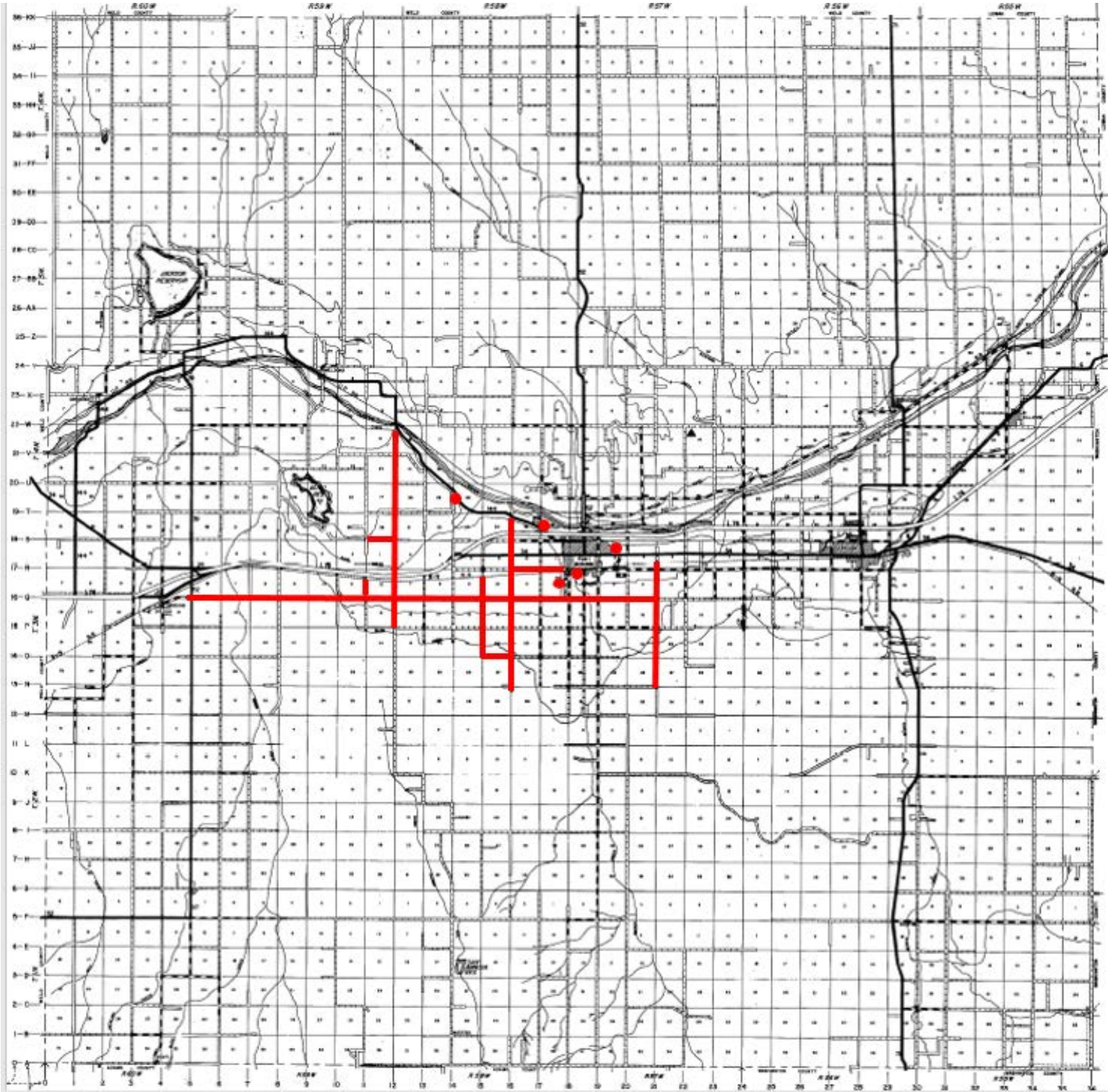

**Morgan County Government
Road Department
2021 Chip Seal Planned Roads**

Project Site	Length in Miles
Road 16, Road O to Hwy 144	4.94
Road 15, Road O to Road Railroad Crossing	2.89
Road O, Road 15 to Road 16	1.02
Road Q, Hwy 52 to Road 21	16.14
Road Q, City Limit to Hwy 52	0.74
Road 12, Road P to Hwy 144	7.40
Road 11, Road Q to End of Pavement	0.54
Road S, Road 11 to Road 12	1.00
Road R, Road 16 to City Limit	1.96
Road 14, End of Pavement to Hwy 144	0.20
Road 21, from Road N to Hwy 34	4.50
Palm Drive from Hwy 144 to Road S.6	0.12
Road S.6 from Palm Drive to Cedar	0.07
Cedar from Road S.6 North to End of Pavement	0.07
N Frontage Road Hwy 144 to Road 17.3	0.33
Road 17.3 from N Frontage Road to Birch	0.11
Arapahoe from West to Colfax	0.09
Colfax from City Limit to City Limit	0.06
Cherokee from West to Colfax	0.08
Deuel Street from Railroad Crossing to City Limit	0.09
Road R from Beginning to Deuel	0.11
8th Ave from City Limit to Barlow	0.50
Saunders	0.12
Total Miles	43.06