

AGENDA
MORGAN COUNTY BOARD OF COUNTY COMMISSIONERS
Assembly Room, Administration Building
231 Ensign Street, Fort Morgan, CO 80701
Tuesday, September 15, 2020

The County Will Be Abiding By the Social Distancing Requirements in Public Health Order 20-28 for This Meeting. Due To Limited Space In The Assembly Room, Remote Attendance Is Encouraged. If You Have Any Questions Regarding Attending The Meeting, Please Contact Karla Powell at 970-542-3500.

To participate in the Citizen's Comment Period you must connect via Zoom Conferencing Access Information: <https://us02web.zoom.us/j/81413848374> If you cannot connect via Zoom, you may submit written public comment to morgancountybcc@co.morgan.co.us by email by 4 p.m. on Monday September 14, 2020.

To participate in Public Hearings you may connect via Zoom Conferencing Access Information: <https://us02web.zoom.us/j/81413848374> or to listen via phone, please dial: 1-312-626-6799, Meeting ID: 814 1384 8374

To watch and/or listen to the meeting but not participate, you may do so by connecting via Zoom Conferencing Access Information: <https://us02web.zoom.us/j/81413848374> or to listen via phone, please dial: 1-312-626-6799, Meeting ID: 814 1384 8374

9:00 A.M.

A. WELCOME – CALL TO ORDER

PLEDGE OF ALLEGIANCE

ROLL CALL:

Commissioner Arndt
Commissioner Becker
Commissioner Zwetzig

The Board of Morgan County Commissioners will convene as the Morgan County Board of Social/Human Services in the matter of:

1. CALL TO ORDER
2. Consideration of Approval –DHS MINUTES dated August 18, 2020
3. Consideration of Approval – DHS WARRANTS July 2020 (Susan Nitzel, Accounting Manager)

*Any meeting or event scheduled to be held at the Commissioners' Offices (218 West Kiowa Avenue, Fort Morgan, CO) will be relocated to a site with handicapped access upon request. For special assistance for the Morgan County Board of Commissioners meeting, please notify us at least 48 hours before the scheduled agenda item. Please call (970)542-3500, extension 1410, to request accommodations for any of the two locations.

PREPARED BY: Karla Powell, Administrative Services Manager
AGENDA POSTED ON Thursday September 10, 2020 @ 1:00 P.M.

4. Consideration of Approval – DHS CERTIFICATION OF PROVIDER AND VENDOR BENEFIT AUTHORIZATIONS July 2020 (Susan Nitzel, Accounting Manager)

STAND IN RECESS

(*Recess as necessary)

B. CITIZEN'S COMMENT PERIOD

Citizens are invited to speak to the Commissioners on non-agenda items. There is a 3 minute time limit per person, unless otherwise noted by the Chairman. Please note that no formal action will be taken on these items during this time due to the open meeting law provision; however, they may be placed on future posted agenda if action is required.

C. ADOPTION OF THE AGENDA

D. CONSENT AGENDA

All matters under the consent agenda are considered to be routine by the Board of County Commissioners and will be enacted with a single vote. There will be no separate discussion of these items. If discussion is deemed necessary, any Board member may ask that the item be removed from the Consent Agenda and considered separately:

1. Ratify the Board of County Commissioners approval of meeting minutes dated September 8, 2020
2. Ratify the Board of County Commissioners approval of Contract 2020 CNT 120 Long Building Technologies, Term of Contract September 2, 2020 until completion
3. Ratify Chairman Mark Arndt's signature on the Veterans Officer report for the month of August, 2020
4. Ratify Chairman Mark Arndt's signature on the Morgan County Public Trustee report dated for August 2020
5. Ratify Commissioner Mark Arndt's signature on Morgan County Warrants for August 2020, signed August 10, 2020
6. Ratify Commissioner Mark Arndt's signature on 2020 Stormwater Inspection Form signed September 14, 2020
7. Ratify Chairman Mark Arndt's signature on Letter of Support to the Colorado Opportunity Scholarship Initiative signed September 14, 2020
8. Ratify the Board of County Commissioners approval on assignment of debt collections to Wakefield and Associates, Client #200187A, #171996

E. GENERAL BUSINESS AND ADMINISTRATIVE ITEMS

1. Consideration of Approval – **2020 BCC 27** Greenwood A Resolution Granting A Use By Special Review For Expansion Of A Non-Conforming Storage Facility Located In The Sw ¼ Of Section 2, Township 3 North, Range 58 West Of The 6th

*Any meeting or event scheduled to be held at the Commissioners' Offices (218 West Kiowa Avenue, Fort Morgan, CO) will be relocated to a site with handicapped access upon request. For special assistance for the Morgan County Board of Commissioners meeting, please notify us at least 48 hours before the scheduled agenda item. Please call (970)542-3500, extension 1410, to request accommodations for any of the two locations.

P.M., Morgan County, Colorado Combined Lots 34 And 35 Of Block 1 Of The Trailside Planned Development, Addressed As 16295 County Road R, Fort Morgan, Colorado 80701 (Pam Cherry, Planning and Zoning Director)

2. Consideration of Approval to Purchase (3) Tandem Axle Dump Trucks with Snow Plow Conversions Utilizing Colorado State Bid Agreement CDOT #311001623 (Bruce Bass, Public Works Director)

F. UNFINISHED BUSINESS

G. COUNTY OFFICIAL AND DEPARTMENT HEAD REPORTS

1. Commissioners Calendar for week of September 11, 2020 through September 22, 2020
2. Road Report

H. ADJOURNMENT

*Any meeting or event scheduled to be held at the Commissioners' Offices (218 West Kiowa Avenue, Fort Morgan, CO) will be relocated to a site with handicapped access upon request. For special assistance for the Morgan County Board of Commissioners meeting, please notify us at least 48 hours before the scheduled agenda item. Please call (970)542-3500, extension 1410, to request accommodations for any of the two locations.

PREPARED BY: Karla Powell, Administrative Services Manager
AGENDA POSTED ON Thursday September 10, 2020 @ 1:00 P.M.

HUMAN SERVICES WARRANTS

[illegible]

I, Jacque Frenier, Director of Human Services of Morgan County, Colorado, hereby confirm that the payments listed below were made to the respective payees totaling the sum as indicated for the month of July 2020.

Date	Director, Jacque Frenier
HMS warrants	\$254,190.27
HMS payroll	\$161,564.11
Total warrants	\$415,754.38

APPROVAL BY COUNTY BOARD OF HUMAN SERVICES

[illegible]

I, Mark Arndt, Chairman of the Board of Human Services of Morgan County, Colorado, hereby confirm that the payments set forth herein have this date been approved, and warrants in payment thereof ordered issued upon the Social Services Fund, accounts as of July 31, 2020 totaling the sum of \$415,754.38.

Date _____ Chairman, Mark Arndt _____

Morgan County Department of Human Services
Warrants List Summary
July 31, 2020

Expenditures:						June	
	7/8/2020	7/15/2020	7/22/2020	7/27/2020	7/31/2020	Month Total	Month Total
Program Costs	5,076.54	3,362.40	3,292.76	3,039.68		14,771.38	10,971.40
Program Contracts	13,311.19	21,964.65				35,275.84	15,313.72
Program Grants	2,952.23	16,011.86	8,095.61	5,135.80		32,195.50	21,467.14
County Interfund	8,529.68	5,774.85	10,103.91			24,408.44	32,939.15
Employee Payroll					62,428.63	62,428.63	63,175.25
Employee Benefits					85,110.48	85,110.48	89,082.37
						-	-
	29,869.64	47,113.76	21,492.28	8,175.48	147,539.11	254,190.27	232,949.03

161,564.11 HMS direct deposits
62,428.63 warrant payroll
223,992.74 gross salary

223,992.74 State upload

Check Register**Morgan County Government**

21-Aug-20

From: 01-Jul-20 To: 31-Jul-20

Check No	Check Date	VendorNo	Vendor	Check Amount	Status
Bank Account: 10 SOCIAL SERVICES FUND					
1020104	08-Jul-20	4496	CHRIS G. BOHLEN	\$60.00	R
1020105	08-Jul-20	503	GREAT COPIER SERVICE IN	\$331.74	R
1020106	08-Jul-20	2912	HEER MORTUARIES AND C	\$1,550.00	R
1020107	08-Jul-20	1043	JEFFREY S. SCHAUERMAN	\$20.00	R
1020108	08-Jul-20	2150	MORGAN CO DEPT. OF HU	\$128.20	R
1020109	08-Jul-20	1085	MORGAN CO FAMILY CENT	\$9,612.48	R
1020110	08-Jul-20	83	MORGAN COUNTY CENTRA	\$871.70	R
1020111	08-Jul-20	6496	MORGAN COUNTY DEPT OF	\$61.60	R
1020112	08-Jul-20	86	MORGAN COUNTY GENERA	\$7,657.98	R
1020113	08-Jul-20	1164	S.H.A.R.E., INC.	\$6,650.94	R
1020114	08-Jul-20	1148	SERVICE MASTER	\$2,925.00	R
1020115	15-Jul-20	7132	A CARING PREGNANCY	\$1,550.14	R
1020116	15-Jul-20	9246	ALLO COMMUNICATIONS LL	\$220.35	R
1020117	15-Jul-20	6580	BABY BEAR HUGS	\$1,545.00	R
1020118	15-Jul-20	736	CENTURYLINK	\$106.92	R
1020119	15-Jul-20	5270	CINTAS	\$118.76	R
1020120	15-Jul-20	8914	CORPORATE TRANSLATION	\$331.27	R
1020121	15-Jul-20	2615	DELUXE MOTEL	\$65.00	R
1020122	15-Jul-20	9247	DISCOVER GOODWILL OF S	\$3,333.33	R
1020123	15-Jul-20	993	EDWARDS RIGHT PRICE MA	\$20.63	R
1020124	15-Jul-20	503	GREAT COPIER SERVICE IN	\$386.42	R
1020125	15-Jul-20	1035	HILL PETROLEUM	\$55.00	R
1020126	15-Jul-20	8431	LEXISNEXIS RISK DATA MG	\$130.00	R
1020127	15-Jul-20	1085	MORGAN CO FAMILY CENT	\$24,478.04	R
1020128	15-Jul-20	9406	MORGAN COUNTY TREASU	\$5,774.85	R
1020129	15-Jul-20	1463	OFFICE DEPOT	\$584.85	R
1020130	15-Jul-20	8120	PATRICIA M CHASE	\$700.00	R
1020131	15-Jul-20	6387	S.A.R.A. INC.	\$7,070.00	R
1020132	15-Jul-20	229	THYSSENKRUPP ELEVATO	\$483.16	R
1020133	15-Jul-20	3003	VERIZON WIRELESS	\$160.04	R
1020134	22-Jul-20	6699	ACCESS PRINTER SUPPLIE	\$467.43	R
1020135	22-Jul-20	2014	ANDREW MCCLARY	\$800.00	R
1020136	22-Jul-20	1393	COLORADO CORRECTIONA	\$105.49	R
1020137	22-Jul-20	9394	DENNA KAYE GILBERT	\$205.72	R
1020138	22-Jul-20	1978	ISABEL WIENS	\$224.98	R
1020139	22-Jul-20	1085	MORGAN CO FAMILY CENT	\$8,095.61	R
1020140	22-Jul-20	83	MORGAN COUNTY CENTRA	\$10,103.91	R
1020141	22-Jul-20	939	NE COLORADO CELLULAR, I	\$435.83	R

Check Register**Morgan County Government**

21-Aug-20

From: 01-Jul-20 To: 31-Jul-20

Check No	Check Date	VendorNo	Vendor	Check Amount	Status
1020142	22-Jul-20	1463	OFFICE DEPOT	\$703.83	R
1020143	22-Jul-20	6954	PRAIRIE MOUNTAIN PUBLIS	\$109.48	R
1020144	22-Jul-20	8658	SHRED IT US HOLDCO, INC	\$40.00	R
1020145	22-Jul-20	8001	YNOSENCIA BARRAZA	\$200.00	R
1020146	28-Jul-20	9421	AMERICAN BIOIDENTITY IN	\$742.50	R
1020147	28-Jul-20	1085	MORGAN CO FAMILY CENT	\$5,135.80	R
1020148	28-Jul-20	3904	WALMART COMMUNITY	\$2,297.18	R
1020149	31-Jul-20	8387	AFLAC GROUP INSURANCE	\$272.65	R
1020150	31-Jul-20	209	AMERICAN FAMILY LIFE AS	\$458.07	R
1020151	31-Jul-20	8449	AMERICAN FIDELITY ASSUR	\$4,515.93	R
1020152	31-Jul-20	8450	AMERICAN FIDELITY ASSUR	\$955.00	R
1020153	31-Jul-20	2391	C H P	\$61,385.98	R
1020154	31-Jul-20	9333	FRANCY LAW FIRM, PC	\$486.28	R
1020155	31-Jul-20	1104	MORGAN CO TREASURER	\$49,544.71	R
1020156	31-Jul-20	2006	MORGAN COUNTY TREAS	\$8,384.94	R
1020157	31-Jul-20	6164	MORGAN COUNTY TREASU	\$21,195.84	R
1020158	31-Jul-20	378	PREPAID LEGAL SERVICES	\$180.40	R
1020159	31-Jul-20	483	STERLING COMMUNITY	\$70.00	R
1020160	31-Jul-20	9375	TEXAS LIFE INSURANCE CO	\$89.31	R
Bank Total:				\$254,190.27	

CERTIFICATION OF PROVIDER, VENDOR AND BENEFIT AUTHORIZATIONS

State of Colorado)
) ss.
County of Morgan)

I, Jacque Frenier, Director of Human Services of Morgan County, Colorado, hereby certify that the payments as set forth on accounts listed below, on pages attached, are made to the respective payees in the amounts set opposite their names, and totaling the sum as indicated for the month of July, 2020. These are actual payments paid in the month of July, 2020. These payments may include benefits from prior months.

Director- Jacques Frenier

Temporary Assistance for Needy Families (TANF)	\$52,123.00
Child Care	\$33,474.26
Foster Care	\$48,438.70
Sub Adopt/RGRDS	\$34,973.45
Core Services	\$18,717.49
LEAP	\$5280.71
Aid to Needy Disabled (AND)	\$7,977.40
Old Age Pension (OAP)	\$32,006.62
Food Assistance Benefits (Food Stamps)	\$743,155.00
Employment 1st	\$25.00

\$976,171.63

APPROVAL BY COUNTY BOARD OF HUMAN SERVICES

State of Colorado)
) ss.
County of Morgan)

I, Mark Arndt, Chairman of the Board of Human Services of Morgan County, Colorado, hereby certify that the authorizations set forth herein have this date been approved, and reimbursement to the state for the county share in the amount listed above is approved.

Chair

EBT-Provider, Vendor, Benefit Authorizations

	Jan-18	Feb-18	Mar-18	Apr-18	May-18	June-18	Jul-18	Aug-18	Sep-18	Oct-18	Nov-18	Dec-18	YTD total
TANF	\$50,715.00	\$45,460.75	\$45,209.00	\$43,800.00	\$39,252.00	\$39,850.00	\$41,408.00	\$76,505.98	\$46,328.00	\$46,871.00	\$47,957.00	\$43,836.00	\$567,192.73
Child Care	\$18,906.85	\$21,388.23	\$29,095.11	\$24,440.44	\$23,815.32	\$23,671.64	\$23,023.84	\$28,196.15	\$20,472.87	\$23,185.34	\$33,597.79	\$30,721.53	\$300,515.11
Foster Care	\$93,492.90	\$98,738.71	\$92,492.59	\$102,149.24	\$95,631.66	\$94,834.92	\$84,656.43	\$55,721.09	\$58,489.62	\$57,626.28	\$60,185.88	\$57,301.85	\$951,321.17
Sub Adopt/ RGRDS													
Core Services	\$19,001.56	\$16,776.66	\$14,096.16	\$14,701.66	\$15,723.21	\$13,472.41	\$14,919.99	\$14,739.09	\$18,963.74	\$15,733.74	\$14,104.99	\$15,887.49	\$167,430.96
LEAP	\$24,039.21	\$75,403.84	\$10,969.15	\$5,236.52	\$102,887.01	\$0.00	\$0.00	\$0.00	\$0.00	\$0.00	\$42,189.69	\$25,020.04	\$285,745.46
AND	\$6,944.29	\$6,425.94	\$5,791.00	\$6,024.45	\$6,316.69	\$7,340.65	\$7,557.00	\$7,444.39	\$8,194.25	\$8,211.70	\$8,755.00	\$9,889.68	\$88,895.04
OAP	\$33,453.38	\$33,679.80	\$36,603.08	\$34,088.82	\$31,104.68	\$31,212.31	\$32,052.21	\$39,216.76	\$35,851.94	\$33,774.31	\$37,550.40	\$35,272.98	\$413,840.67
Food Stamps	\$314,707.23	\$304,068.85	\$311,598.00	\$304,977.00	\$302,759.00	\$299,437.00	\$312,365.00	\$313,767.00	\$299,949.00	\$297,256.00	\$293,592.00	\$295,938.00	\$3,650,414.08
Empl 1st	\$425.00	\$550.00	\$625.00	\$375.00	\$300.00	\$550.00	\$325.00	\$405.00	\$50.00	\$250.00	\$125.00	\$25.00	\$4,005.00
Total	\$561,685.42	\$602,492.78	\$546,479.09	\$535,773.13	\$617,789.57	\$510,368.93	\$516,307.47	\$569,914.11	\$522,228.61	\$515,737.97	\$571,981.67	\$546,522.17	\$6,617,280.92

monthly average \$551,440.08

	Jan-19	Feb-19	Mar-19	Apr-19	May-19	June-19	Jul-19	Aug-19	Sep-19	Oct-19	Nov-19	Dec-19	YTD total
TANF	\$38,913.00	\$46,839.00	\$41,794.00	\$42,779.00	\$45,783.00	\$51,292.00	\$56,479.58	\$52,229.00	\$51,672.00	\$50,973.00	\$48,753.00	\$48,272.50	\$575,779.08
Child Care	\$38,713.35	\$29,697.22	\$26,385.60	\$28,140.10	\$27,815.90	\$21,258.44	\$21,281.59	\$24,592.58	\$18,591.39	\$25,718.81	\$21,104.86	\$20,857.28	\$304,157.12
Foster Care	\$55,960.25	\$57,002.73	\$59,241.75	\$77,111.76	\$80,286.33	\$83,822.60	\$80,728.52	\$90,279.46	\$77,661.97	\$74,116.70	\$70,482.45	\$63,945.80	\$870,640.32
Sub Adopt/ RGRDS	\$34,245.92	\$34,409.07	\$31,079.16	\$33,956.28	\$33,829.98	\$34,850.89	\$32,855.70	\$33,950.89	\$35,780.89	\$32,677.95	\$34,409.71	\$33,419.30	\$405,465.74
Core Services	\$16,423.65	\$13,489.99	\$13,319.99	\$12,080.99	\$16,104.99	\$12,259.99	\$13,576.66	\$17,471.66	\$14,089.99	\$14,679.99	\$16,054.99	\$19,213.74	\$178,766.63
LEAP	\$21,926.65	\$76,567.61	\$6,432.99	\$10,712.25	\$51,736.40	\$0.00	\$0.00	\$0.00	\$0.00	\$0.00	\$36,169.18	\$23,885.48	\$227,430.56
AND	\$8,934.00	\$6,765.00	\$7,257.00	\$7,433.00	\$6,992.63	\$8,560.56	\$7,252.80	\$7,486.18	\$9,095.00	\$7,166.00	\$9,009.50	\$10,707.87	\$96,659.54
OAP	\$37,797.23	\$35,800.97	\$35,649.26	\$34,213.56	\$32,432.01	\$37,362.89	\$33,301.75	\$33,383.64	\$32,779.38	\$32,111.15	\$38,505.93	\$42,114.74	\$425,452.51
Food Stamps	\$288,803.00	\$289,351.00	\$293,861.00	\$281,232.00	\$283,434.00	\$283,471.00	\$278,495.00	\$278,461.00	\$276,556.00	\$283,025.00	\$285,387.00	\$286,067.00	\$3,408,143.00
Empl 1st	\$125.00	\$200.00	\$150.00	\$125.00	\$150.00	\$50.00	\$100.00	\$50.00	\$25.00	\$200.00	\$225.00	\$125.00	\$1,525.00
Total	\$541,842.05	\$590,122.59	\$515,170.75	\$527,783.94	\$578,565.24	\$532,928.37	\$524,071.60	\$537,904.41	\$516,251.62	\$520,668.60	\$560,101.62	\$548,608.71	\$6,494,019.50

monthly average \$541,168.29

	Jan-20	Feb-20	Mar-20	Apr-20	May-20	June-20	Jul-20	Aug-20	Sep-20	Oct-20	Nov-20	Dec-20	YTD total
TANF	\$51,184.00	\$46,659.00	\$51,824.00	\$59,786.00	\$59,146.46	\$52,382.88	\$52,123.00						\$373,105.34
Child Care	\$29,483.64	\$25,504.78	\$24,337.59	\$41,993.73	\$34,784.12	\$34,065.68	\$33,474.26						\$223,643.80
Foster Care	\$55,457.11	\$53,342.41	\$45,333.45	\$50,107.23	\$47,906.42	\$46,425.93	\$48,438.70						\$347,011.25
Sub Adopt/ RGRDS	\$34,886.65	\$34,571.80	\$33,087.55	\$35,369.45	\$34,228.50	\$35,369.45	\$34,973.45						\$242,486.85
Core Services	\$15,791.87	\$17,974.29	\$23,713.18	\$19,404.99	\$18,739.08	\$18,614.08	\$18,717.49						\$132,954.98
LEAP	\$26,797.27	\$86,486.09	\$11,852.31	\$5,897.69	\$5,092.29	\$152,521.17	\$5,280.71						\$293,927.53
AND	\$9,646.00	\$8,654.47	\$7,737.59	\$7,337.00	\$9,242.00	\$9,842.00	\$7,977.40						\$60,436.46
OAP	\$35,048.50	\$37,312.60	\$34,472.98	\$34,760.51	\$32,919.94	\$39,918.26	\$32,006.62						\$246,439.41
Food Stamps	\$292,215.00	\$278,618.82	\$287,301.00	\$695,901.00	\$520,507.00	\$537,788.00	\$743,155.00						\$3,355,485.82
Empl 1st	\$225.00	\$25.00	\$175.00	\$100.00	\$0.00	\$0.00	\$25.00						\$550.00
Total	\$550,735.04	\$589,149.26	\$519,834.65	\$950,657.60	\$762,565.81	\$926,927.45	\$976,171.63	\$0.00	\$0.00	\$0.00	\$0.00	\$0.00	\$5,276,041.44

monthly average \$753,720.21

EBT Last month to Current month comparison

Program	Cases	July 20	June 20	Difference
TANF		\$52,123.00	\$52,382.88	(\$259.88)
Child Care		\$33,474.26	\$34,065.68	(\$591.42)
Foster Care	16 / 16	\$48,438.70	\$46,425.93	\$2,012.77
Sub Adopt/ RGRDS	72 / 73	\$34,973.45	\$35,369.45	(\$396.00)
Core Services	88 / 88	\$18,717.49	\$18,614.08	\$103.41
LEAP		\$5,280.71	\$152,521.17	(\$147,240.46)
AND		\$7,977.40	\$9,842.00	(\$1,864.60)
OAP	131 / 132	\$32,006.62	\$39,918.26	(\$7,911.64)
Food Stamps	1406 / 1378	\$743,155.00	\$537,788.00	\$205,367.00
Empl 1st		\$25.00	\$0.00	\$25.00
Total		\$976,171.63	\$926,927.45	\$49,244.18

Year to Year By month

Program	Cases	July 20	July 19	Difference
TANF		\$52,123.00	\$56,479.58	(\$4,356.58)
Child Care		\$33,474.26	\$21,281.59	\$12,192.67
Foster Care	16 / 24	\$48,438.70	\$80,728.52	(\$32,289.82)
Sub Adopt/ RGRDS	88 / 68	\$34,973.45	\$32,855.70	\$2,117.75
Core Services	88 / 63	\$18,717.49	\$13,576.66	\$5,140.83
LEAP		\$5,280.71	\$0.00	\$5,280.71
AND		\$7,977.40	\$7,252.80	\$724.60
OAP	131 / 139	\$32,006.62	\$33,301.75	(\$1,295.13)
Food Stamps	1406 / 1142	\$743,155.00	\$278,495.00	\$464,660.00
Empl 1st		\$25.00	\$100.00	(\$75.00)
Total		\$976,171.63	\$524,071.60	\$452,100.03

**MORGAN COUNTY, COLORADO
BOARD OF COUNTY COMMISSIONERS**

RESOLUTION 2020 BCC 27

A RESOLUTION GRANTING A USE BY SPECIAL REVIEW FOR EXPANSION OF A NON-CONFORMING STORAGE FACILITY LOCATED IN THE SW ¼ OF SECTION 2, TOWNSHIP 3 NORTH, RANGE 58 WEST OF THE 6TH P.M., MORGAN COUNTY, COLORADO COMBINED LOTS 34 AND 35 OF BLOCK 1 OF THE TRAILSIDE PLANNED DEVELOPMENT, ADDRESSED AS 16295 COUNTY ROAD R, FORT MORGAN, COLORADO 80701

WHEREAS, Charles Greenwood III (the "Owner") has applied for a special use permit to allow the expansion of a non-conforming storage facility on Block 1, combined lots 34 and 35 of the Trailside Planned Development located in the SW ¼ of Section 2, Township 3 North, Range 58 West of the 6th P.M., Morgan County, and addressed as 16295 County Road R, Fort Morgan, CO (the "Property");

WHEREAS, the application seeks approval of a special use permit for the following:

1. A new 180 x 50 foot storage building adjacent to an existing building on the northern portion of the Property;
2. The addition of storage units along the exterior of an existing building designated as Building 108; and
3. Additional outdoor storage to the north of an existing 40 x 70 foot building;

WHEREAS, these new structures and uses are shown on the site plan submitted by the Owner and attached hereto as **Exhibit A** and the approval set forth in this Resolution is limited to those structures and uses listed above;

WHEREAS, the proposed 120 x 60 foot building shown as a "Personal Shop" is not subject to the approval set forth herein, because it is a use-by-right and no special use permit is required for such a structure and use. In the event the structure is used for purposes other than a personal shop by the Owner and such use is not a use-by-right, Owner shall comply with the applicable Zoning requirements at the time, which may prohibit the use or require a special use permit;

WHEREAS, on July 13, 2020, after holding a duly noticed public hearing, the Morgan County Planning Commission recommended that the Application be approved with certain conditions;

WHEREAS, on August 5, 2020, the Board of County Commissioners of Morgan County, Colorado held a public hearing on the Application;

WHEREAS, notice of the public hearing before the Board of County Commissioners was properly published and the notice was properly posted at the Property;

WHEREAS, during the public hearing the Board of County Commissioners received testimony and evidence from staff, the Owner and the public; and

WHEREAS, after considering all relevant testimony and evidence, the Board of County Commissioners desires to approve the Application, subject to certain conditions set forth herein.

NOW, BE IT RESOLVED BY THE BOARD OF COUNTY COMMISSIONERS OF MORGAN COUNTY, COLORADO:

1. APPROVAL

The application is hereby granted, subject to the conditions set forth herein. This Resolution shall constitute the special use permit (hereinafter referred to as this “Resolution” or the “Permit”).

2. FINDINGS OF FACT

Subject to the Owner meeting and complying with all conditions set forth herein, the following findings are made:

- a. The use and its location are in conformance with the Morgan County Comprehensive Plan:
 - i. The project will encourage infill in existing business and industrial subdivision.
 - ii. The project is in proximity to activity centers and compatible with existing land use with access to established infrastructure.
- b. All the application documents are complete and present a clear picture of how uses are to be arranged on the site.
- c. The Site Plan conforms to the district design standards of these Regulations.
- d. All on and off-site impacts have been satisfactorily mitigated by incorporating six foot privacy fencing to buffer this use from adjacent residential uses.
- e. The special use proposed has been made compatible with the surrounding uses and adequately buffered by the incorporation of 6 foot privacy fencing along the property lines

- f. This use poses only the minimum amount of risk to public health, safety and welfare.
- g. The Special Use is located on conforming parcel that is part of the Trailside Planned Development.
- h. The Owner has adequately documented a public need for the project in the form of increased economic development and providing a needed service in Morgan County. The Owner has submitted all pertinent technical information, adequate financial resources to implement the project, and has paid all County fees and review costs.
- i. The Owner has demonstrated that there is an existing Morgan County Quality Water tap which is adequate for the proposed use in terms of quantity, quality and reliability.

3. CONDITIONS

The approval of the use by special review is conditioned upon the following:

- a. The Owner shall obtain necessary permits and comply with the requirements and conditions of those permits as determined by other governmental agencies with jurisdiction over this operation.
- b. The use of the approved structures shall be limited to private storage. Other uses, including without limitation manufacturing, workshop space, distribution (such as the drop off, pick up, or shipping of products, supplies, or materials) are prohibited and not hereby permitted.
- c. The uses for this property shall comply with the Trailside Planned Development Plan.
- d. A 6' privacy fence shall be constructed along the northern boundary of the Property where the "Proposed 6' Privacy Fence" is designated on the site plan and along the west side of the Property boundary adjacent to the retention pond where designated on the site plan. When the storage units are constructed along the outside of Building 108 (as designated on the site plan) the 6' privacy fence shall be extended along the entire west side of the Property boundary.
- e. The existing grain bins shall be removed.
- f. The retention pond shall be constructed as designed and shown in the Application and will include plans for mitigation of odors and pests.
- g. A lighting plan shall be submitted and approved by the Planning Administrator prior to installation of new lighting.

4. GENERAL PROVISIONS

- a. The Board of County Commissioners retains continuing jurisdiction over this Permit to ensure compliance with this Permit and the Morgan County Zoning Regulations.
- b. County Representatives are authorized to inspect the Property at any reasonable time upon notice to the Owner.
- c. This approval is conditioned on compliance with all information and representations contained in the Application and presented by the Owner, which are hereby incorporated into this Resolution.
- d. The Owner shall comply and ensure compliance by third parties with all requirements, conditions and design standards set forth herein. Noncompliance shall be grounds for revocation of this permit by the Morgan County Board of Commissioners after notice and hearing.

DATED this 15th day of September, 2020 *nunc pro tunc August 5, 2020*.

**BOARD OF COUNTY COMMISSIONERS
MORGAN COUNTY, COLORADO**

Mark A. Arndt, Chair

James P. Zwetzig, Commissioner

Jon J. Becker, Commissioner

ATTEST:

Susan Bailey, Clerk to the Board

Morgan County
Tandem Axle Dump Trucks with Snow Plow Conversion

State of Colorado Bid Agreement CDOT # 311001623

Company	Item	Price
McCandless Truck Center	2021 International HV513 SFA 6x4 Truck <i>See Specifications</i>	131,093.00
O.J. Watson	O.J. Watson Body Allied Equipment Conversion <i>See Specifications</i>	70,200.00
Total Vehicle Each		201,293.00
Total for Three (3) Vehicles		603,879.00



O.J. Watson Company, Inc.
5335 Franklin Street
Denver, Colorado 80216
303-295-2885 or 800-332-2124
Fax: 303-296-8049
www.ojwatson.com

Quotation

Page 1 of 12

Customer: MORGAN
Morgan County Government
Fleet Department
PO Box 189
Fort Morgan CO 80701

Contact: Bruce Bass
Phone: 970-542-3569
2nd :
Email:

Salesperson: Gary Werning

Quote Number: MRE1205

Quote Date: 8/11/2020

Quote valid until: 9/10/2020

Revision Number: 0

Work Order:

Build Information:

Year / Make / Model	2021 International	End User	
Cab Configuration	REGULAR	Unit #	
Fuel Type	DIESEL	Item / PO#	
CA / CT			
Rear Axle	TANDEM		

Quoted Items:

Description of Work

O.J. Watson Company, Inc. is pleased to submit the following quotation with pricing in accordance with OJW City & County of Denver Contract No SC-00003211 including:

DUMP BODY:

- Crysteel MAB-SLTS-84/96-1500-16Y-RC690 54/46/46V
- **Body Style: SELECT Body Length: 14'-0"**
- **Body ID: 84**
- **Body OD: 96**
- **Hoist Mounting Type: STANDARD**
- Hoist Model: M63138
- Front Style: STRAIGHT
- Side Style: 3/4 DOUBLE WALL
- Rear Style: STRAIGHT
- **Frame Style: 8 WESTERN TUBULAR**
- Crossmember Type: NA
- Crossmember Spacing: NA
- Front Height: 60
- Side Height Front: 34
- Side Height Rear: 34
- Rear Height: 42
- Front Material: 10GA A1011 STEEL
- Side Material: 10GA A1011 STEEL
- Rear Material: 10GA A1011 STEEL
- Floor Material: 3/16 AR450 STEEL
- Frame Material: 1/4 A1011 STEEL-1/4 A1011 STEEL
- Outer Side Material: 10GA A1011 STEEL
- Rear Pillar Width: 18
- **Tailgate Release Type: AIR**
- Tailgate Hinge Type: 1.5 THICK / 7 OFFSET
- Tailgate Thickness: 3.5
- Tailgate Bracing Style: FULLRIB



O.J. Watson Company, Inc.
5335 Franklin Street
Denver, Colorado 80216
303-295-2885 or 800-332-2124
Fax: 303-296-8049
www.ojwatson.com

Quotation

Page 2 of 12

Description of Work

- Side Vertical Quantity: 0
- Front Brace Quantity: 1
- Chain Slot Bracket Type: BANJO

DUMP BODY LIGHTING:

- Rear Light Cutouts: 2 OVALS
- 3/4" LED marker lights
- Combination 3-ID w/stop-tail-turn functions installed below center of frame with 1" round stock framework

CAB SHIELD:

- Weld on full cab shield, 40" x 88" -10ga
- 4 oval cutouts w/ enclosure
- 2 forward & 1 on each side
- 3" channel on bulkhead & 1 1/4" conduit underneath

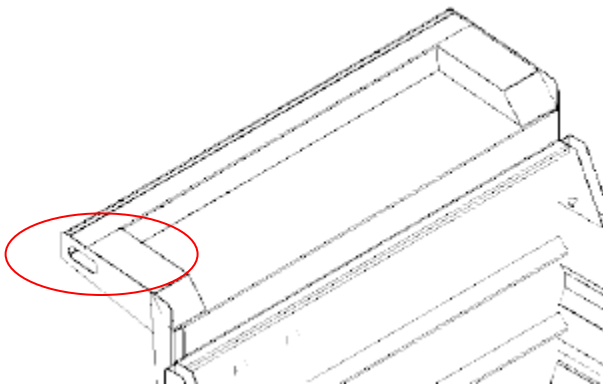

SPILL SHIELD:

- 8" x 10" 10 gauge spill shield
- Quick disconnect attachment to match MS966CD mounting hardware

PAINT:

- Prime Body: ALL
- BLACK finish coat

CRYSTEEL MARATHON HOIST:

- Crysteel M63138 in NTEA class 120
- Operating pressure of 2500 PSI
- 50-degree dumping angle
- Single acting (double acting optional)
- 3 stages (6", 5", 4") and 138" stroke
- Lifting capacity 46.4 tons
- Inverted cylinder, trunnion mounted
- 8" structural channel longitudinal required
- Two body props to support empty body weight
- Critical rotating pivot points equipped with composite bearings
- 9-1/2" square doghouse
- The hoist cylinder shall incorporate the "Auto Bleed" technology, an internal spring assisted device to automatically remove air from the cylinder and hydraulic lines whenever the cylinder is extended and retracted. The device shall not bleed air directly to atmosphere and shall use hydraulic fluid to push air out of the cylinder and back to tank.



O.J. Watson Company, Inc.
5335 Franklin Street
Denver, Colorado 80216
303-295-2885 or 800-332-2124
Fax: 303-296-8049
www.ojwatson.com

Quotation

Page 3 of 12

Description of Work

Floating Cradle

- Hoist shall be equipped with a lower mount consisting of a retaining box with an inner, floating cylinder mount that accommodates some truck frame movement without moving the telescopic cylinder, reducing the stress on the telescopic cylinder.

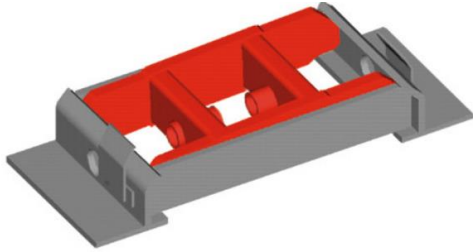

WARRANTY:

- Dump body, hoist, and air cylinder to be covered for a period of 5 years. Warranty begins when the final customer puts our product into service. This warranty will cover the dump body, hoist, and air cylinder for defective material and/or workmanship at a rate of 100% for the first (3) years and at a rate of 50% for years 4 and 5.
- Capacities based on water-level load, 12" overhang, 50° dump angle and includes body weight

TARP:

Pull Tarp electric tarp assembly including:

- Asphalt rated tarp material
- Cab mounted switch

CHIPPER BAR:

Custom fabricated chipper bar including:

- 1/2" plate side and angle support gussets
- 2" solid round stock bar center

CHIPPER BAR NOTE:

- EXACT dimensions and location of bar MUST be provided PRIOR to fabrication

MUD FLAPS:

- ADOT-style remove-n-stow mud flap brackets
- Rubber flaps front and rear of tandems

MISCELLANEOUS ITEMS:

- -2- weight tickets
- Conspicuity Tape along both rub rails of body, entire length



O.J. Watson Company, Inc.
5335 Franklin Street
Denver, Colorado 80216
303-295-2885 or 800-332-2124
Fax: 303-296-8049
www.ojwatson.com

Quotation

Page 4 of 12

Description of Work

SNOWPLOW:

Furnish and install -1- new Monroe MP41R12-ISCT snowplow including:



- **One piece A569 3/16" steel roll formed moldboard**
- Integral shield style moldboard
- Six 1/2" x 4" one-piece solid flame cut ribs that taper to 2" at the top of the moldboard
- 2" x 3" x 3/8" top moldboard angle
- 4" x 4" x 3/4" bottom moldboard angle
- 3" x 3" x 1/4" non-spring horizontal angle bracing
- 3" x 3" x 1/2" horizontal spring support angle bracing
- Dual compression trip spring assemblies with shear bolts
- Monroe built in level lift assembly
- Main push tube is 4" x 4" x 3/8" A36 steel seamless wall tubing
- Fabricated from A36 steel 3-1/2 x 3-1/2 1/2" semi-circle
- Moldboard and frame to be 100% continuously welded
- Moldboard to be shot blasted and powder coat painted ORANGE
- Push frame to be powder coat painted BLACK
- Two 3" x 10" power reverse cylinders with cushion valve protection
- 5/8" x 8" AASHTO C1080 top-punched cutting edge
- **Rubber snow deflector**
- Orange poly sight markers
- **Screw adjustable parking jack**
- **The moldboard height of the plow is 41 inches**
- **The moldboard width of the plow is 12 feet**



O.J. Watson Company, Inc.
5335 Franklin Street
Denver, Colorado 80216
303-295-2885 or 800-332-2124
Fax: 303-296-8049
www.ojwatson.com

Quotation

Page 5 of 12

Description of Work

TRUCK HITCH:

- MC-7092 Truck portion quick hitch with fold flat lift arm
- 1/2" Side plate kit
- 4"x10" Double acting lift cylinder

PLOW HITCH:

- MC-6000 plow portion quick hitch

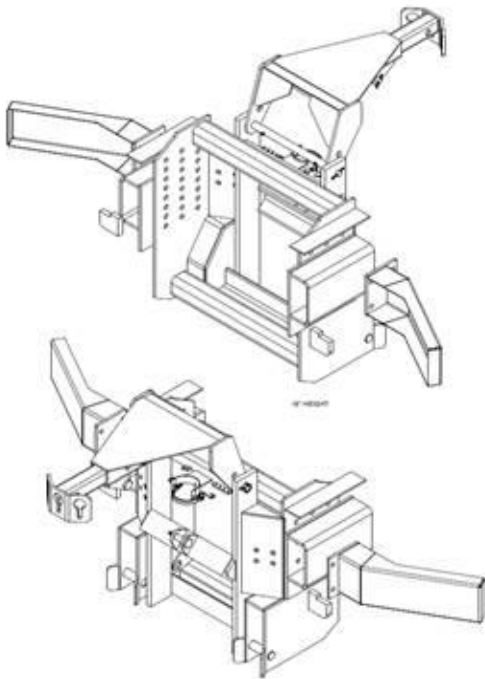

PAINT:

- Moldboard is powder coated ORANGE
- Mounting assemblies are powder coated BLACK



O.J. Watson Company, Inc.
5335 Franklin Street
Denver, Colorado 80216
303-295-2885 or 800-332-2124
Fax: 303-296-8049
www.ojwatson.com

Quotation

Page 6 of 12

Description of Work

Furnish and install -1- Monroe Under-Tailgate, Chain Drive Spreader model MS966-CD complete including:



Note: Image shows available option of 201 stainless steel construction which is NOT included. See Option section for pricing.

- **Mild Steel construction**
- 6" Dia. Auger w/ Flighting for **Center Discharge**
- 7 Ga., 96" Trough w/ 1/4" End Plates
- One-Piece, Removable & Hinged, Combination Cover & Rear Panel
- Heavy-Duty, Steel Rod, Captive Latches
- Quick Detach Mounting Brackets
- Tailgate Shields
- ORANGE powder coat paint

Furnish and install -1- new Force America front crank shaft drive hydraulic system including:

- 4.88 cid pump - CCW - 1-1/4" keyed - 4 Bit C - L.S. - 2" x 1" SFP side - Compensation = 3100 psi - 4800 psi max
- Standard Driveline Kit With 479 & 329 Flange Yokes
- Full Port High PSI Ball Valve 5000 PSI
- Full Port 2" NPT Brass Ball Valve 600 PSI

Tank Detail:

- GEN 2 VT-35 with POLY lid assembly
- In-tank return filter
- Temp/level Sender
- Filter breather
- Magnetic drain plug
- 100 mesh suction strainer



O.J. Watson Company, Inc.
5335 Franklin Street
Denver, Colorado 80216
303-295-2885 or 800-332-2124
Fax: 303-296-8049
www.ojwatson.com

Quotation

Page 7 of 12

Description of Work



Valve Detail:

- Force add-a-stack
- 3000 PSI max
- **MANUAL: CABLE controller**
- SA Hoist
- DA plow with standard float and 500 PSI downside relief
- DA plow angle
- 0-14 GPM auger
- 0-7 GPM spinner

Electronic Spreader Control Detail:

- FA 5100EX-3F Spreader control with calibration key
- Floor mounted

MISCELLANEOUS ITEMS:

- All required hoses and fittings
- Standard style quick couplers
- Hydraulic oil



O.J. Watson Company, Inc.
5335 Franklin Street
Denver, Colorado 80216
303-295-2885 or 800-332-2124
Fax: 303-296-8049
www.ojwatson.com

Quotation

Page 8 of 12

Description of Work



Image of 5100 EX Electric Sander Controller



O.J. Watson Company, Inc.
5335 Franklin Street
Denver, Colorado 80216
303-295-2885 or 800-332-2124
Fax: 303-296-8049
www.ojwatson.com

Quotation

Page 9 of 12

Description of Work

LIGHTING:

Furnish and install the following Whelen LED DOT lighting system including:

Whelen "500" series strobe lights as follows:

- -1- Amber/Amber strobe light mounted in a box in cab shield corner, facing forward, streetside
- -1- Amber/Amber strobe light mounted in a box in cab shield corner, facing sideways, streetside
- -1- Amber/Amber strobe light grommet mounted in the rear pillar of body, facing sideways, streetside
- -1- Amber/Amber strobe light grommet mounted in the rear pillar of body, facing rear, streetside
- -1- Amber/Blue strobe light mounted in a box in cab shield corner, facing forward, curbside
- -1- Amber/Blue strobe light mounted in a box in cab shield corner, facing sideways, curbside
- -1- Amber/Blue strobe light grommet mounted in the rear pillar of body, facing sideways, curbside
- -1- Amber/Blue strobe light grommet mounted in the rear pillar of body, facing rear, curbside
- Whelen linear DOT LED lighting system ran from the cab of the truck to each light without the use of a junction box. All light connections will have Deutsch connections. All wiring will be run with TPR-cables. All cab shield lights will be mounted in Whelen steel mounting boxes with 12" protective flex tubing for strain relief.
- -2- RED stop / tail / turn LED lights mounted in rear bolster
- -2- WHITE back up lights LED recessed in the rear bolster
- -4- RED clearance lights, -2- per side installed in rear body pillars to conform to DOT standards

SWITCHING:

Lighting is to be controlled by truck OEM auxiliary switches installed in dash

- ALL amber lights to be controlled by -1- OEM dash switch
- ALL blue lights to be controlled by -1- OEM dash switch

SNOWPLOW LIGHTS:

ABL 3800 LED style snowplow lights including:

- Five (5) function FULL LED
- Heated lens
- 100 % waterproof housing
- Stainless steel snowplow lights to mount to OEM fender mounted mirrors





O.J. Watson Company, Inc.
5335 Franklin Street
Denver, Colorado 80216
303-295-2885 or 800-332-2124
Fax: 303-296-8049
www.ojwatson.com

Quotation

Page 10 of 12

Description of Work

DUMP BODY LIGHTING

- LED markers lights
- Signal Stat model 6050 or approved equal LED style 3-ID light, wired to include stop/tail & turn installed on cover plate between frame rails directly Chipper hitch and is to include a protective bumper constructed of 1" round stock

Total Price Not Including Options: \$69,500.00



O.J. Watson Company, Inc.
5335 Franklin Street
Denver, Colorado 80216
303-295-2885 or 800-332-2124
Fax: 303-296-8049
www.ojwatson.com

Quotation

Page 11 of 12

Optional Items:

Options	Amount	Accepted
ADD FOR: <ul style="list-style-type: none">30.5" Husting Hitch components for both truck and plow portions in lieu of "SD" style quick hitch.	\$2,865.00	Yes / No
ADD FOR: <ul style="list-style-type: none">201 stainless steel construction on MS966 CD tailgate sander	\$700.00	Yes / No
ADD FOR: <ul style="list-style-type: none">Force America Patrol Commander Electric controls for plow and dump operation in lieu of cable.	\$3,625.00	Yes / No



Patrol Commander Dual with side-by-side
mounted 5100ex Spreader Control



O.J. Watson Company, Inc.
5335 Franklin Street
Denver, Colorado 80216
303-295-2885 or 800-332-2124
Fax: 303-296-8049
www.ojwatson.com

Quotation

Page 12 of 12

Notes:

- All quotes are F.O.B. Denver unless otherwise stated.
- Quotes are subject to all applicable sales and use taxes including F.R.E.T.
- Open Account Terms are Net 30 upon delivery.
- Cash Account Term is payment at time of delivery (cash/check/credit card) and is subject to a 50% deposit requirement upon initial order.
- All credit card transactions over \$7,000.00 will be subject to a 3% processing fee.
- The contents of this quote are confidential and not intended for distribution. It is strictly forbidden to share this quote with any third party without written consent from O.J. Watson Equipment.

Accepted

By: _____ Quoted By: _____ Mark Eckrich **FOR** Gary Werning

Date: _____ Date: _____ 08.13.2020

Prepared For:
 MORGAN COUNTY
 Bruce Bass
 218 W Kiowa Ave.
 Fort Morgan, CO 80701-2314
 (970)542 - 3500
 Reference ID: CDOT #311001623

Presented By:
 MCCANDLESS TRUCK CENTER LLC
 Ron Wasinger
 16704 EAST 32ND AVENUE
 AURORA CO 80011 -
 (303)739-9900

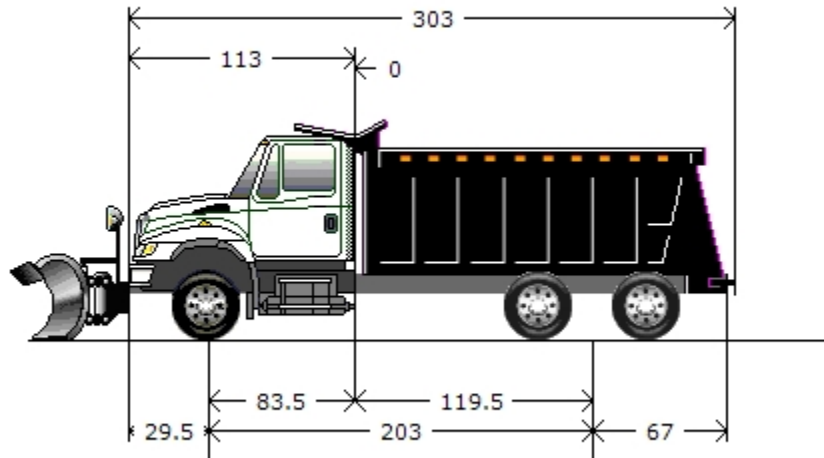

Model Profile
2021 HV513 SFA (HV513)

AXLE CONFIG:	6X4
MISSION:	Requested GVWR: 58000. Calc. GVWR: 60000 Calc. Geared Speed: 92.8 MPH
DIMENSION:	Wheelbase: 203.00, CA: 119.50, Axle to Frame: 67.00
ENGINE, DIESEL:	{International A26} EPA 2017, 500HP @ 1700 RPM, 1750 lb-ft Torque @ 1000 RPM, 2100 RPM Governed Speed, 500 Peak HP (Max)
TRANSMISSION, AUTOMATIC:	{Allison 4500 RDS} 5th Generation Controls, Wide Ratio, 6-Speed with Double Overdrive, with PTO Provision, Less Retarder, Includes Oil Level Sensor, On/Off Highway
CLUTCH:	Omit Item (Clutch & Control)
AXLE, FRONT NON-DRIVING:	{Meritor MFS-20-133A} Wide Track, I-Beam Type, 20,000-lb Capacity
AXLE, REAR, TANDEM:	{Meritor MT-40-14X-5DCR-P} Single Reduction, 40,000-lb Capacity, with Lube Oil Pump, . 5"(12.7mm) Wall Housing Thickness, Driver Controlled Locking Differential in Forward-Rear and Rear-Rear Axle, R Wheel Ends Gear Ratio: 4.33
CAB:	Conventional, Day Cab
TIRE, FRONT:	(2) 315/80R22.5 Load Range L HAU 3 WT (CONTINENTAL), 480 rev/mile, 68 MPH, All-Position
TIRE, REAR:	(8) 11R24.5 Load Range H HDR2 (CONTINENTAL), 468 rev/mile, 75 MPH, Drive
SUSPENSION, REAR, AIR, TANDEM:	{Hendrickson PRIMAAX EX} 46,000-lb Capacity, 55" Axle Spacing, 9.0" Ride Height, with Shock Absorbers
PAINT:	Cab schematic 100WM Location 1: 9219, Winter White (Std) Chassis schematic N/A

Description

Base Chassis, Model HV513 SFA with 203.00 Wheelbase, 119.50 CA, and 67.00 Axle to Frame.

TOW HOOK, FRONT (2) Frame Mounted

AXLE CONFIGURATION {Navistar} 6x4

Notes

: Pricing may change if axle configuration is changed.

FRAME RAILS Heat Treated Alloy Steel (120,000 PSI Yield); 10.866" x 3.622" x 0.437" (276.0mm x 92.0mm x 11.1mm); 456.0" (11582mm) Maximum OAL

BUMPER, FRONT Swept Back, Steel, Heavy Duty

FRAME EXTENSION, FRONT Integral; 20" In Front of Grille

CROSSMEMBER, FRONT for Hydraulic Pump, Mounting Flange to Accommodate Pump

WHEELBASE RANGE 199" (505cm) Through and Including 264" (670cm)

AXLE, FRONT NON-DRIVING {Meritor MFS-20-133A} Wide Track, I-Beam Type, 20,000-lb Capacity

SUSPENSION, FRONT, SPRING Parabolic Taper Leaf, Shackle Type, 20,000-lb Capacity, with Shock Absorbers

SPRINGS, FRONT AUXILIARY Air Bag, Right Side Only, Driver Control

BRAKE SYSTEM, AIR Dual System for Straight Truck Applications

Includes

: BRAKE LINES Color and Size Coded Nylon

: DRAIN VALVE Twist-Type

: GAUGE, AIR PRESSURE (2) Air 1 and Air 2 Gauges; Located in Instrument Cluster

: PARKING BRAKE CONTROL Yellow Knob, Located on Instrument Panel

: PARKING BRAKE VALVE For Truck

: QUICK RELEASE VALVE On Rear Axle for Spring Brake Release: 1 for 4x2, 2 for 6x4

: SPRING BRAKE MODULATOR VALVE R-7 for 4x2, SR-7 with relay valve for 6x4/8x6

TRAILER CONNECTIONS Four-Wheel, with Hand Control Valve and Tractor Protection Valve, for Straight Truck

Notes

: When electronic stability control is ordered with trailer connections on a 4x2 truck, please check the operator manual for trailer weight restrictions.

DRAIN VALVE {Berg} with Pull Chain, for Air Tank

AIR BRAKE ABS {Bendix AntiLock Brake System} 4-Channel (4 Sensor/4 Modulator) Full Vehicle Wheel Control System

AIR DRYER {Bendix AD-IP} with Heater

BRAKE CHAMBERS, REAR AXLE {Bendix EverSure} 30/30 SqIn Spring Brake

BRAKE CHAMBERS, FRONT AXLE {Bendix} 24 SqIn

SLACK ADJUSTERS, FRONT {Gunitite} Automatic

SLACK ADJUSTERS, REAR {Gunitite} Automatic

AIR COMPRESSOR {Bendix BA-921 Head Unload} 15.9 CFM

AIR DRYER LOCATION Mounted Inside Left Rail, Back of Cab

AIR TANK LOCATION (2) Mounted Under Battery Box, Outside Right Rail, Back of Cab, Perpendicular to Rail

DUST SHIELDS, FRONT BRAKE for Air Cam Brakes

DUST SHIELDS, REAR BRAKE for Air Cam Brakes

Description

BRAKES, REAR {Meritor 16.5X7 Q-PLUS CAST} Air S-Cam Type, Cast Spider, Fabricated Shoe, Double Anchor Pin, Size 16.5" X 7", 23,000-lb Capacity per Axle

BRAKES, FRONT {Meritor 16.5X6 Q-PLUS CAST} Air S-Cam Type, Cast Spider, Fabricated Shoe, Double Anchor Pin, Size 16.5" X 6", 20,000-lb Capacity

PARK BRAKE CHAMBERS, ADDITIONAL (2) Spring Brake Type

STEERING COLUMN Tilting and Telescoping

STEERING WHEEL 4-Spoke; 18" Dia., Black

STEERING GEAR (2) {Sheppard M100/M80} Dual Power

DRIVELINE SYSTEM {Dana Spicer} SPL250 Main Driveline with SPL170 Interaxle Shaft, for 6x4

AFTERTREATMENT COVER Aluminum

EXHAUST SYSTEM Single, Horizontal Aftertreatment Device, Frame Mounted Right Side Under Cab, for Single Vertical Tail Pipe, Frame Mounted Right Side Back of Cab

ENGINE COMPRESSION BRAKE by Jacobs; for N13/A26 Engines, with Selector Switch and On/Off Switch

TAIL PIPE (1) Turnback Type, Bright

MUFFLER/TAIL PIPE GUARD (1) Bright Stainless Steel

EXHAUST HEIGHT 10'

SWITCH, FOR EXHAUST 3 Position, Momentary, Lighted Momentary, ON/CANCEL, Center Stable, INHIBIT REGEN, Mounted in IP Inhibits Diesel Particulate Filter Regeneration When Switch is Moved to ON While Engine is Running, Resets When Ignition is Turned OFF

ELECTRICAL SYSTEM 12-Volt, Standard Equipment

Includes

: DATA LINK CONNECTOR For Vehicle Programming and Diagnostics In Cab

: HAZARD SWITCH Push On/Push Off, Located on Instrument Panel to Right of Steering Wheel

: HEADLIGHT DIMMER SWITCH Integral with Turn Signal Lever

: PARKING LIGHT Integral with Front Turn Signal and Rear Tail Light

: STARTER SWITCH Electric, Key Operated

: STOP, TURN, TAIL & B/U LIGHTS Dual, Rear, Combination with Reflector

: TURN SIGNAL SWITCH Self-Cancelling for Trucks, Manual Cancelling for Tractors, with Lane Change Feature

: WINDSHIELD WIPER SWITCH 2-Speed with Wash and Intermittent Feature (5 Pre-Set Delays), Integral with Turn Signal Lever

: WINDSHIELD WIPERS Single Motor, Electric, Cowl Mounted

: WIRING, CHASSIS Color Coded and Continuously Numbered

CIGAR LIGHTER Includes Ash Cup

HORN, ELECTRIC (2) Disc Style

SNOW SHIELD (2) Chrome; for Dual Air Horns

JUMP START STUD (2) Remote Mounted

ALTERNATOR {Leece-Neville AVI160P2013} Brush Type, 12 Volt, 160 Amp Capacity, Pad Mount

BODY BUILDER WIRING Back of Day Cab at Left Frame or Under Sleeper, Extended or Crew Cab at Left Frame; Includes Sealed Connectors for Tail/Amber Turn/Marker/ Backup/Accessory Power/Ground and Sealed Connector for Stop/Turn

HORN, AIR (2) Single Tone, Chrome, Roof Mounted, with Lanyard Pull Cord

BATTERY SYSTEM {Fleetrite} Maintenance-Free, (3) 12-Volt 2850CCA Total, Top Threaded Stud

2-WAY RADIO Wiring Effects; Wiring with 20 Amp Fuse Protection, Includes Ignition Wire with 5 Amp Fuse, Wire Ends Heat Shrink and 10' Coil Taped to Base Harness

Description

BATTERY DISCONNECT SWITCH {Cole-Hersee 75920-06} 300 Amp, Disconnects Cab Power, Does Not Disconnect Charging Circuits, Locks with Padlock, Battery Box Mounted

SPEAKERS (2) 6.5" Dual Cone Mounted in Both Doors, (2) 5.25" Dual Cone Mounted in Both B-Pillars

CB RADIO Accommodation Package; Header Mounted; Feeds From Accessory Side of Ignition Switch; Includes Power Source and Two (2) Antennas, Antenna Bases with Wiring on Both Side Mirrors

RADIO AM/FM/WB/Clock/Bluetooth/USB Input/Auxiliary Input

AUXILIARY HARNESS 3.0' for Auxiliary Front Head Lights and Turn Signals for Front Plow Applications

TRAILER CONNECTION SOCKET 7-Way, Mounted at Rear of Frame, Wired for Turn Signals Independent of Stop, Compatible with Trailers with Amber or Side Turn Lamps

BATTERY BOX Steel, with Plastic Cover, 18" Wide, 2-4 Battery Capacity, Mounted Right Side Back of Cab

BACK-UP ALARM {Preco 1059} Electronic; Solid State, Dual Function, 112 dBA

WINDSHIELD WIPER SPD CONTROL Force Wipers to Slowest Intermittent Speed When Park Brake Set and Wipers Left on for a Predetermined Time

SWITCH, TOGGLE, FOR WORK LIGHT Lighted; on Instrument Panel and Wiring Effects for Customer Furnished Back of Cab Light

CLEARANCE/MARKER LIGHTS (5) {Truck Lite} Amber LED Lights, Flush Mounted on Cab or Sunshade

TEST EXTERIOR LIGHTS Pre-Trip Inspection will Cycle all Exterior Lamps Except Back-up Lights

HEADLIGHTS ON W/WIPERS Headlights Will Automatically Turn on if Windshield Wipers are turned on

ALARM, PARKING BRAKE Electric Horn Sounds in Repetitive Manner When Vehicle Park Brake is "NOT" Set, with Ignition "OFF" and any Door Opened

STARTING MOTOR {Mitsubishi Electric Automotive America 105P} 12-Volt, with Soft-Start

HEADLIGHTS AUTO Automatically Turn On with Low Ambient Light Levels, Feature can be Overridden

CIRCUIT BREAKERS Manual-Reset (Main Panel) SAE Type III with Trip Indicators, Replaces All Fuses

TURN SIGNALS, FRONT Includes LED Side Turn Lights Mounted on Fender

POWER SOURCE, ADDITIONAL Auxiliary Power Outlet (APO) & USB Port, Located in the Instrument Panel

FENDER EXTENSIONS Rubber

LOGOS EXTERIOR Model Badges

LOGOS EXTERIOR, ENGINE Badges

GRILLE Stationary, Chrome

INSULATION, SPLASH PANELS for Sound Abatement

BUG SCREEN Mounted Behind Grille

FRONT END Tilting, Fiberglass, with Three Piece Construction, Includes Long Hood

PAINT SCHEMATIC, PT-1 Single Color, Design 100

Includes

: PAINT SCHEMATIC ID LETTERS "WM"

PAINT TYPE Base Coat/Clear Coat, 1-2 Tone

PROMOTIONAL PACKAGE Government Silver Package

MUD FLAP HOLDER Spring Loaded, Painted Black, 45-Degree End, with Red and White Reflective Tape, Less Flaps

CLUTCH Omit Item (Clutch & Control)

Description

ANTI-FREEZE Red, Extended Life Coolant; To -40 Degrees F/ -40 Degrees C, Freeze Protection

PTO EFFECTS, ENGINE FRONT for N13/A26 Engines, Less PTO, Unit, Includes Adapter Plate on Engine Front Mounted

ENGINE, DIESEL {International A26} EPA 2017, 500HP @ 1700 RPM, 1750 lb-ft Torque @ 1000 RPM, 2100 RPM Governed Speed, 500 Peak HP (Max)

FAN DRIVE {Horton Drivemaster} Two-Speed Type, Direct Drive, with Residual Torque Device for Disengaged Fan Speed

Includes

: FAN Nylon

AIR CLEANER Dual Element, with Integral Snow Valve and In-Cab Control

FEDERAL EMISSIONS {International A26} EPA, OBD and GHG Certified for Calendar Year 2020

ACCESSORY WIRING, SPECIAL for Road Speed Wire Coiled Under Instrument Panel for Customer Use

COLD STARTING EQUIPMENT Automatic; with Engine ECM Control

FAN DRIVE SPECIAL EFFECTS Fan Cooling Ring with Fan Shroud Effects, Engine Mounted

EMISSION COMPLIANCE Federal, Does Not Comply with California Clean Air Idle Regulations

RADIATOR Aluminum, Welded, Cross Flow, Front to Back System, 1292 SqIn, with 1008 SqIn Charge Air Cooler

Includes

: DEAERATION SYSTEM with Surge Tank

: HOSE CLAMPS, RADIATOR HOSES Gates Shrink Band Type; Thermoplastic Coolant Hose Clamps

: RADIATOR HOSES Premium, Rubber

BLOCK HEATER, ENGINE {Phillips} 120V/1150W

TRANSMISSION, AUTOMATIC {Allison 4500 RDS} 5th Generation Controls, Wide Ratio, 6-Speed with Double Overdrive, with PTO Provision, Less Retarder, Includes Oil Level Sensor, On/Off Highway

OIL COOLER, AUTO TRANSMISSION {Modine} Water to Oil Type

TRANSMISSION SHIFT CONTROL Column Mounted Stalk Shifter, Not for Use with Allison 1000 & 2000 Series Transmission

TRANSMISSION OIL Synthetic; 63 thru 76 Pints

ALLISON SPARE INPUT/OUTPUT for Rugged Duty Series (RDS) and Regional Haul Series (RHS), General Purpose Trucks, Construction, Package Number 223

NEUTRAL AT STOP OMIT

TRANSMISSION TCM LOCATION Located Inside Cab

SHIFT CONTROL PARAMETERS {Allison} 3000 or 4000 Series Transmissions, Performance Programming

PTO LOCATION Customer Intends to Install PTO at Left Side of Transmission

SUSPENSION AIR CONTROL VALVE Pressure Release Control In Cab

AXLE, REAR, TANDEM {Meritor MT-40-14X-5DCR-P} Single Reduction, 40,000-lb Capacity, with Lube Oil Pump, .5"(12.7mm) Wall Housing Thickness, Driver Controlled Locking Differential in Forward-Rear and Rear-Rear Axle, R Wheel Ends . Gear Ratio: 4.33

SUSPENSION, REAR, AIR, TANDEM {Hendrickson PRIMAAX EX} 46,000-lb Capacity, 55" Axle Spacing, 9.0" Ride Height, with Shock Absorbers

AXLE, REAR, LUBE {EmGard FE-75W-90} Synthetic Oil; 50 thru 64.99 Pints

DEF TANK 9.5 US Gal (36L) Capacity, Frame Mounted Outside Left Rail, Under Cab

FUEL/WATER SEPARATOR {Davco Fuel Pro 382} Includes Water-in-Fuel Sensor

LOCATION FUEL/WATER SEPARATOR Mounted Outside Left Rail, 46" Back of Cab

Description

FUEL TANK Top Draw, Non-Polished Aluminum, 26" Dia, 80 US Gal (303L), Mounted Left Side, Under Cab

CAB Conventional, Day Cab

HEATER SHUT-OFF VALVES (1) Ball Valve Type, Supply Line

AUTOMATIC CLIMATE CONTROL Automatically Maintains Cabin Comfort Based on Selected Temperature

AIR CONDITIONER with Integral Heater and Defroster

GAUGE CLUSTER Premium Level; English with English Speedometer and Tachometer, for Air Brake Chassis, Includes Engine Coolant Temperature, Primary and Secondary Air Pressure, Fuel and DEF Gauges, Oil Pressure Gauge, Includes 5 Inch LCD Color Display

GAUGE, OIL TEMP, AUTO TRANS for Allison Transmission

GAUGE, AIR CLEANER RESTRICTION {Filter-Minder} with Black Bezel, Mounted in Instrument Panel

IP CLUSTER DISPLAY On Board Diagnostics Display of Fault Codes in Gauge Cluster

SEAT, DRIVER {National 2000} Air Suspension, High Back with Integral Headrest, Cloth, Isolator, 1 Chamber Lumbar, 2 Position Front Cushion Adjust, -3 to +14 Degree Back Angle Adjust

SEAT, PASSENGER {National} Air-Suspension, High Back with Integral Headrest, Cloth, Isolated, 1 Chamber Lumbar, 2 Position Front Cushion Adjustment, -3 to +14 Degree Seat Back Adjustment

GRAB HANDLE, EXTERIOR Chrome, Towel Bar Type, with Anti-Slip Rubber Inserts, for Cab Entry Mounted Left Side at B-Pillar

MIRROR, CONVEX, HOOD MOUNTED {Lang Mekra} (2) Right and Left Sides, Bright, Heated, 7.5" Sq.

MIRRORS (2) Aero Pedestal, Power Adjust, Heated, Turn Signals, Bright Heads, Black Arms, 6.5" x 14" Flat Glass, Includes 6.5" x 6" Convex Mirrors, for 102" Load Width

Notes

: Mirror Dimensions are Rounded to the Nearest 0.5"

MIRROR, CONVEX, LOOK DOWN Right Side, Bright, 6" x 10.5"

CAB INTERIOR TRIM Diamond, for Day Cab

Includes

: CONSOLE, OVERHEAD Molded Plastic with Dual Storage Pockets, Retainer Nets and CB Radio Pocket; Located Above Driver and Passenger

: DOME LIGHT, CAB Door Activated and Push On-Off at Light Lens, Timed Theater Dimming, Reading Lights; Integral to Overhead Console, Center Mounted

: SUN VISOR (3) Padded Vinyl; 2 Moveable (Front-to-Side) Primary Visors, Driver Side with Vanity Mirror and Toll Ticket Strap, plus 1 Auxiliary Visor (Front Only), Driver Side

ARM REST, RIGHT, DRIVER SEAT

WINDOW, POWER (2) and Power Door Locks, Left and Right Doors, Includes Express Down Feature

CAB REAR SUSPENSION Air Bag Type

INSTRUMENT PANEL Wing Panel

MODESTY PANEL Painted

SUNSHADE, EXTERIOR Aerodynamic, Painted Roof Color, with Integral Clearance/Marker Lights

ACCESS, CAB Steel, Driver & Passenger Sides, Two Steps per Door, for use with Day Cab and Extended Cab

WHEELS, FRONT {Accuride 29300} DISC; 22.5x9.00 Rims, Powder Coat Steel, 5-Hand Hole, 10-Stud, 285.75mm BC, Hub-Piloted, Flanged Nut, with Steel Hubs

WHEELS, REAR {Accuride 28827} DUAL DISC; 24.5x8.25 Rims, Powder Coat Steel, 10-Stud, 285.75mm BC, Hub-Piloted, Flanged Nut, with .472" Thick Increased Capacity Disc and with Steel Hubs

Description

BDY INTG, REMOTE POWER MODULE (2) Mounted Inside Cab Behind Driver Seat, Up to 6 Outputs & 6 Inputs Each, Max 20 amp per Channel, Max 80 amp Total; Includes 2 Switch Packs with Latched Switches

BDY INTG, PTO ACCOMMODATION for Electric over Hydraulic PTO, Does Not Include Solenoids, with Latched Switch Mounted on Dash Includes Audible Alarm and Indicator Light in Gauge Cluster (Requires 1 Remote Power Module input & 1 output)

(8) TIRE, REAR 11R24.5 Load Range H HDR2 (CONTINENTAL), 468 rev/mile, 75 MPH, Drive

(2) TIRE, FRONT 315/80R22.5 Load Range L HAU 3 WT (CONTINENTAL), 480 rev/mile, 68 MPH, All-Position

Cab schematic 100WM

Location 1: 9219, Winter White (Std)

Chassis schematic N/A

Services Section:

WARRANTY Standard for HV513, HV613 Models, Effective with Vehicles Built July 1, 2017 or Later, CTS-2030A

SERVICES, TOWING {Navistar} Service Call to 36-Month/Unlimited Mileage to the Nearest Navistar Dealer for Navistar Warrantable Failure as Contract Defined; Includes Engine Failure if Supplier Declines Tow Coverage & ESC Supplied thru Navistar; \$1100 (USA) Maximum Benefit per Incident

SRV CONTRACT, EXT ENGINE {Navistar} To 36-Month/300,000 Miles (480,000 km), Includes Engine, Engine Electronics, Turbocharger, Water Pump and Fuel Injectors, for International A26 Engines

OJ WATSON PACKAGE

<u>Description</u>	(US DOLLAR)	<u>Price</u>
Total Factory List Price Including Options:		\$250,582.00
Total Preparation And Delivery:		\$5,000.00
Freight	\$2,350.00	
Total Freight:		\$2,350.00
Total Factory List Price Including Freight:		\$257,932.00
Less Customer Allowance:		(\$126,839.00)
Total Vehicle Price:		\$131,093.00
Total Body/Allied Equipment:		\$70,200.00
Total Sale Price:		\$201,293.00
Total Per Vehicle Sales Price:		\$201,293.00
Net Sales Price:		\$201,293.00

Thank you for the opportunity to offer our quotation for your equipment needs. We look forward to your acceptance of this proposal. All prices are firm for thirty days from the date of this quotation. Prices are subject to revision after this date. Payment terms are C.O.D. No credit card payments will be accepted. Pricing may be subject to federal, state, local taxes and surcharges at time of invoicing.

Despite all efforts by McCandless Truck Center LLC to meet delivery dates, certain contingencies which cannot be foreseen or guarded against may cause delays in production and delivery. Customer agrees that McCandless Truck Center, LLC shall not be held liable for any damages for delays in delivery.

Approved by Seller:

Accepted by Purchaser:

Official Title and Date

Firm or Business Name

Authorized Signature

Authorized Signature and Date

MCCANDLESS TRUCK CENTER LLC
16704 EAST 32ND AVENUE
AURORA CO 80011 -
(303)739-9900

This proposal is not binding upon the seller without
Seller's Authorized Signature

Official Title and Date

The TOPS FET calculation is an estimate for reference purposes only. The seller or retailer is responsible for calculating and reporting/paying appropriate FET to the IRS.

The limited warranties applicable to the vehicles described herein are Navistar, Inc.'s standard printed warranties which are incorporated herein by reference and to which you have been provided a copy and hereby agree to their terms and conditions.

COMMISSIONERS CALENDAR

September 11, 2020 through September 22, 2020

September 11, 2020	10:00 a.m.	CCI Eastern District Meeting
September 14, 2020	10:30 a.m. 12:00 p.m. 1:00 p.m.	Planning and Zoning Hearing - Degenhart Human Resources Department Meeting Preliminary Department Budget Meetings 1:00 p.m.-2:00 p.m. (see website)
September 15, 2020	9:00 a.m. 9:05 a.m. 12:00 p.m.	DHS Financial Meeting Board of County Commissioners Meeting (Assembly Room) (Please check https://morgancounty.colorado.gov/ for meeting options.) Tourism Panel Board Meeting-Virtual (Becker)
September 16, 2020	9:30 a.m. 1:00 p.m.	NECALG (Zwetzig) Planning & Zoning Director Meeting
September 17, 2020	8:30 a.m. 9:00 a.m.	KFTM Radio Interview Attorney Office Hours
September 18, 2020		No Meetings Scheduled
September 21, 2020	10:30 a.m.	Building Maintenance Department Meeting
September 22, 2020	9:00 a.m. 10:00 a.m.	Board of County Commissioners Meeting (Assembly Room) (Please check https://morgancounty.colorado.gov/ for meeting options.) DHS Agency Meeting

Unless otherwise noted, all meetings with department heads and other non-BOCC elected officials listed above may include an update on the status of the department, a general discussion of projects, any matters or concerns that the County needs to address, and activities and operations of the department.

Department meetings may be by conference call or virtual meeting upon request.

CALENDAR SUBJECT TO CHANGE DUE TO AGREEABLE CANCELLATIONS AND/OR WALK IN BUSINESS

****All meetings are held in the Commissioner's Office located at 218 West Kiowa Avenue, Fort Morgan unless otherwise noted**

Posted 09/10/2020 @ 1:00 P.M. by Karla Powell, Administrative Services Manager

*Any meeting or event scheduled to be held at the Commissioners' Offices (218 West Kiowa Avenue, Fort Morgan, CO) will be relocated to a site with handicapped access upon request. For special assistance for the Morgan County Board of Commissioners meeting, please notify us 48 hours before the scheduled agenda item. Please call (970)542-3500, extension 1410, to request accommodation.